

# General Information

PRAIRIELAKE® Interior Doors are manufactured by Woodharbor Doors & Cabinetry, Inc. Woodharbor continuously seeks to refine and improve its product offerings and reserves the right to make changes and improvements in materials, specifications and designs without prior notice. Woodharbor is not obligated to incorporate such changes in products previously manufactured.

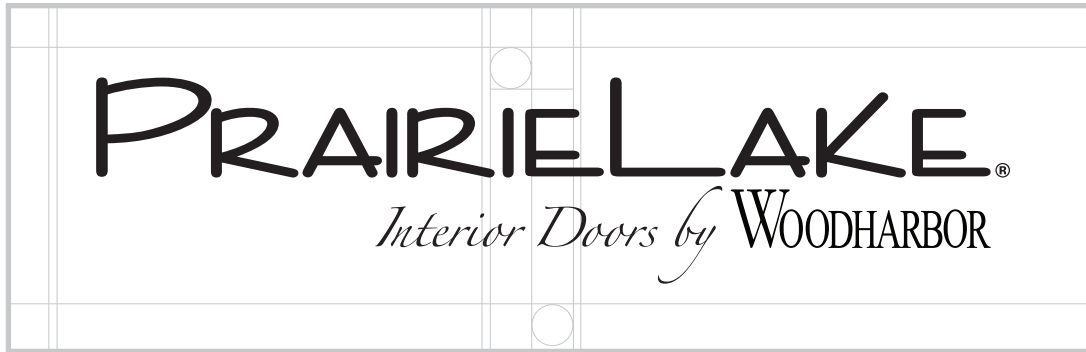

# Table of Contents

|                                   |         |
|-----------------------------------|---------|
| <b>General Information</b>        | 1 - 26  |
| Product Summary                   | 3       |
| Door Construction                 | 4       |
| Glass Information                 | 4       |
| Door Types                        | 5       |
| Door Collections                  | 6       |
| Profile Options                   | 7       |
| Dimensional Information           | 8       |
| Door Thickness/Arch Options       | 9       |
| Pre-Hung Doors (Jambs)            | 10 - 11 |
| Door Handing                      | 12      |
| Double Door Hardware              | 13      |
| Hinging                           | 14 - 16 |
| Machining                         | 17      |
| Effects of Moisture in Wood       | 18      |
| Wood Species                      | 19      |
| Finish Details                    | 20 - 21 |
| Door Sizing Diagrams              | 22 - 24 |
| Warranty/Installation Information | 25 - 26 |
| <b>Door Styles</b>                | 27 - 46 |
| "Richmond" Doors (Raised Panel)   | 27 - 28 |
| "Fairmont" Doors (Flat Panel)     | 29 - 30 |
| "Glass" Doors (True Divided Lite) | 31 - 40 |
| "Paintable" Doors                 | 39 - 46 |
| <b>"Fire Rated" Doors</b>         | 41 - 62 |

## General Information

# PRAIRIELAKE®

*Interior Doors by* WOODHARBOR

- 16 Raised Panel Door Styles - "Richmond" (see pages 27 - 28)
- 3 V-Grooved Raised Panel Door Styles - "Richmond" (see pages 27 - 28)
- 17 Flat Panel Door Styles - "Fairmont" (see pages 29 - 30)
- 10 Glass Door Styles - True Divided Lite (Compression fit glass) (see pages 31 - 38)
- Paintable/MDF Door Styles - Raised, Flat and Glass (see pages 38 - 46)

### **Construction:**

Composite Core with solid wood edges & matching veneer

4 3/4" stiles/rails, 8" lock/bottom rail

*Dowel joinery*

Solid Wood/MDF Raised Panels (3/4" or 1 1/8" thick) or

Composite Core/MDF Plywood Flat Panels (3/8" thick)

*Expansion/Contraction cushions around panels*

**Wood Species:** Red Oak, Poplar, Cherry, Maple, Birch, Select Alder, Knotty Alder, Paintable

**Profiles:** Raised Panel Doors have a "Cove/Bead" Profile

Flat Panel Doors have a "Cove/Bead", "Mission", or "Prairie" Profile

Glass Panel Doors have a "Cove/Bead" or "Mission" Profile

**Stop Mldg:** CSTOP or PSTOP

**Sizes:** Standard catalog widths (passage, double, by-pass, bi-fold, pocket)

**Heights:** 6/8, 7/0 & 8/0 (7/0 & 8/0 doors may require additional lead time of 1-2 weeks)

**Thickness:** 1 3/8" and 1 3/4" ('A' & 'B' Series)

**Finish:** Unfinished standard, selected Spray Stain finish available for an upcharge (see pages 20 - 21)  
(Paintable is base primed)

**Custom:** Custom heights or widths are available (3/0 maximum width and 8/0 maximum height)  
(see page 28) - Custom size components are not available. Custom size components are not available.

**Hinges:** Satin Brass or Polished Brass Hinges standard - All other stocked hinge finishes available for an upcharge.  
PBB Architectural grade, Plain Bearing (PB), 5 knuckle butt hinges standard. Optional Ball Bearing (BB) hinges available at an upcharge. (see page 14)

**Jams:** Fingerjointed (Pine), Composite Core, Lumber Core & Solid Wood

## DOOR CONSTRUCTION

### STILES & RAILS:

Stiles and rails of PRAIRIELAKE® Interior Doors are constructed of veneered "composite core". "Composite Core" stiles and rails are engineered for strength and stability (to eliminate lumber's natural tendency to warp or move with changes in humidity.)

Inside and outside edges are then banded with solid wood to match the wood species on the faces of the door. A veneer is glued under heat and pressure to both faces of the stile/rail. Stiles and rails are then grooved and profiled on the inside edge to receive the panel.

Stiles and rails are joined with a mortise and tenon joint and are double dowelled and cold glued for optimum strength and stability. The bottom rail and lock rail are triple dowelled. (Dowels are 3/2" x 1/2" grooved hardwood.)

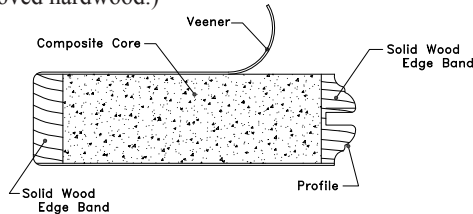

### CENTER PANELS:

**Raised Panels:** Raised panels are a nominal 3/4" or 1 1/8" thick staved solid wood or MDF.

**Flat (Recessed) Panels:** Flat panels are 3/8" thick composite-core plywood or MDF.

**Panel Retention:** Regardless of the method of retention, solid wood panels must have the freedom and room to expand or contract in reaction to changes in ambient humidity.

PRAIRIELAKE Interior Doors are engineered with a unique "floating panel" system that allows expansion and contraction and yet secures the panel to prevent shifting, settling and rattling. Special, flexible cushions are inserted into the stile and rail groove. Panels are then placed into the groove to rest against the cushions. The cushions allow expansion and contraction while holding the panel in position.

See page 40 for Paintable/MDF construction.

### "RICHMOND"

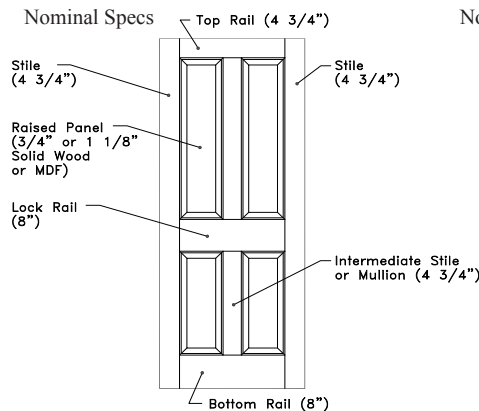

### "FAIRMONT"

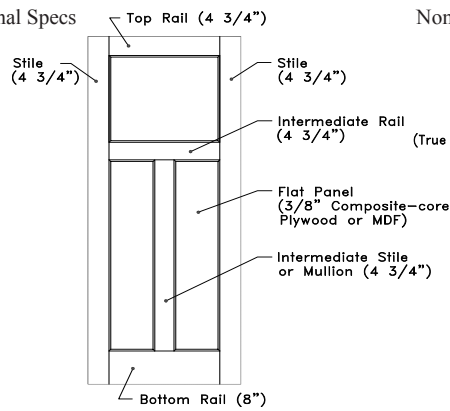

### "GLASS DOOR"

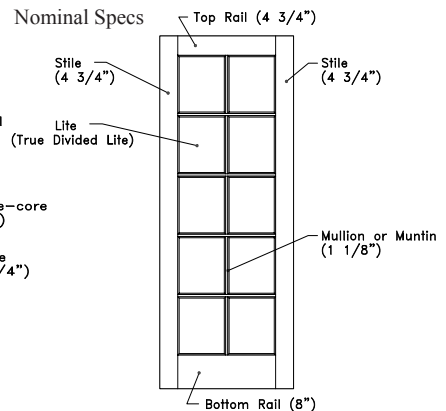

## GLASS INFORMATION

### TRUE DIVIDED LITE CONSTRUCTION:

All "glass" doors are crafted as True Divided Lite. (Each lite of glass is an individual pane of glass.) Glass is installed in the door with a "compression fit" - which means each pane of glass is built into the door and secured within the profile groove. A variety of decorative insert options are available.

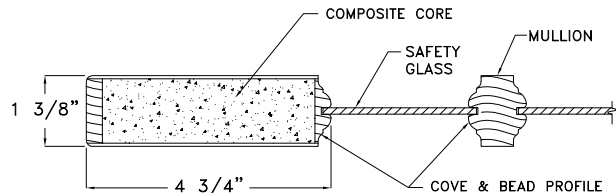

### "SAFETY" GLASS:

All glass supplied or installed is a "safety" glass. Tempered safety glass has a small stamp in the lower right corner of each pane as required by building codes.

### PLASTIC-WRAPPED GLASS FOR PROTECTION:

All glass is plastic wrapped from the glass manufacturer for protection during shipment, handling, installation and finishing. To remove plastic wrap after final installation of the door, carefully pull the wrap away from the glass while cutting. Use a new, sharp razor blade - Insert the blade under the edge of the stop molding and carefully cut the plastic. **Do not touch the glass with the cutting blade - Use caution when removing the plastic wrap to prevent scratching the glass.**

# General Information

## DOOR TYPES

Doors are categorized into several "Door Types" based on their use. Passage, Double, Pocket, Double Pocket, Bi-Fold and By-Pass. Based on this designation, doors are appropriately sized and machined and appropriate hardware is included (if applicable).

**PASSAGE DOOR:** A Passage Door is a single door slab that is specified as a "Door Only" or a "Pre-Hung". Pre-Hung Passage Doors are beveled and hinged based on the LH or RH designation indicated on the order form.

**DOUBLE DOORS:** Double doors include 2 doors that can be specified as "Doors Only" or as a Pre-Hung unit within a single jamb. Each door is hinged and often times, additional hardware (astragal with flush bolts, ball catches, etc.) is specified.

**POCKET DOOR:** When a Pocket Door is specified, the jamb is sent loose. The header and one leg are split to accommodate the functioning of the hardware. (Hardware is not included because it is typically sourced locally for installation before the sheet-rock/plaster. Take care to install appropriate hardware for 1 3/8" or 1 3/4" thick pocket doors.) If jambs are not needed, a passage door only (slab) can be ordered without a "handing" designation.

**DOUBLE POCKET DOORS:** When Double Pocket Doors are ordered, the jamb is sent loose with the header and both legs split to accommodate the functioning of the hardware. (Hardware is not included because it is typically sourced locally for installation prior to the sheet-rock/plaster. Take care to install appropriate hardware for 1 3/8" or 1 3/4" thick pocket doors.) If jambs are not needed, passage door slabs (door only) can be ordered without a "handing" designation.

**BI-FOLD DOORS:** Bi-Fold Doors can be ordered with or without jambs. Bi-Fold track hardware is always included. (Heavy-duty hardware is supplied with 1 3/4" thick doors.) Bi-Fold doors are under-sized in height to accommodate the track hardware. Bi-Fold door slabs are hinged at the factory. The hinges are not visible from the face when the doors are closed (satin brass). Jambs (if specified) are sent loose. A wood, fascia trim is included to conceal the track hardware after installation.

**BY-PASS DOORS:** By-Pass Doors can be ordered with or without jambs. By-Pass track hardware is always included. (Heavy-duty hardware is supplied with 1 3/4" thick doors.) By-Pass doors are under-sized in height to accommodate the track hardware. When jambs are ordered, the header jamb is sized 1" under nominal width so that the By-Pass doors will overlap by 1". Jambs (if specified) are sent loose. A wood, fascia trim is included to conceal the track hardware after installation.

*For dimensional specifications, see page 8.*

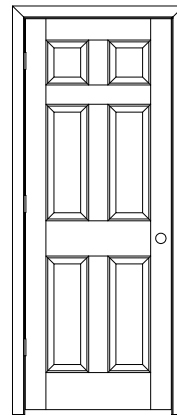
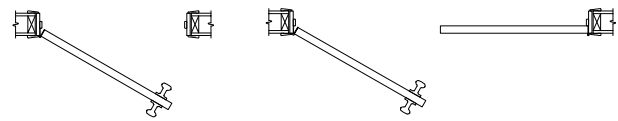

Passage

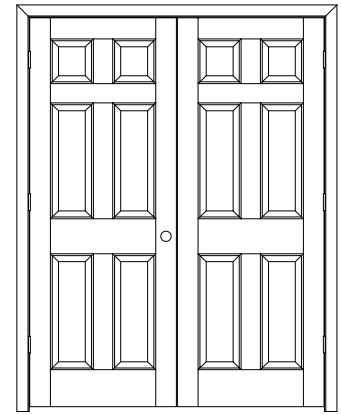

Double

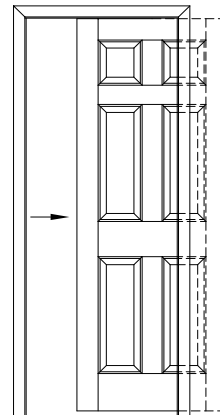
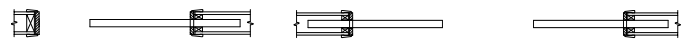

Pocket

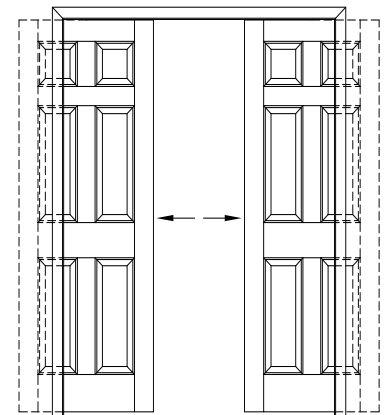

Double Pocket

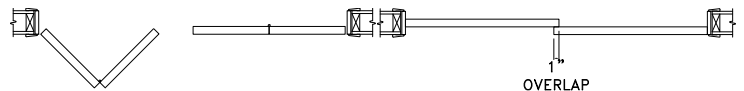

OVERLAP

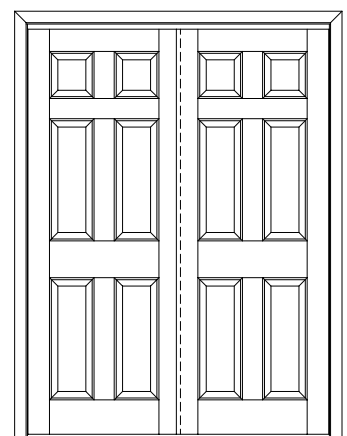
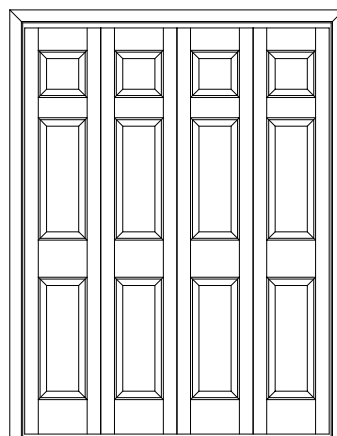

## DOOR STYLE COLLECTIONS

PrairieLake offers several different collections of door styles. These collections are differentiated by an overall design element (raised panel vs. flat panel) and/or their basic construction.

**RICHMOND:** The "Richmond" collection includes a series of door styles that are constructed with solid wood raised panels and composite core stiles/rails. Richmond doors are available with a "Cove/Bead" Profile. Richmond doors are available 1 3/8" or 1 3/4" thick. 1 3/4" thick doors can be ordered as 'A' Series (3/4" thick panels) or as 'B' Series (1 1/8" thick panels).

**RICHMOND 1 3/8"**

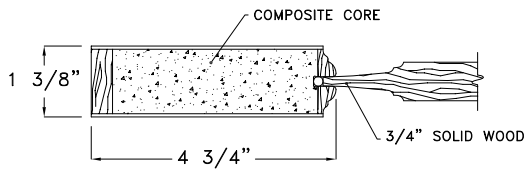

**RICHMOND 1 3/4" - 'A' SERIES**

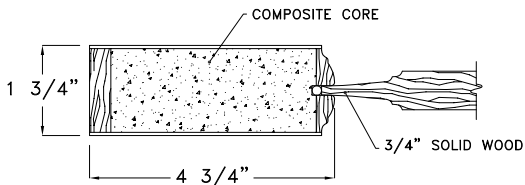

**RICHMOND 1 3/4" - 'B' SERIES**

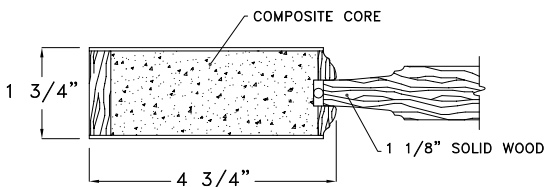

**FAIRMONT:** The "Fairmont" collection includes a series of door styles that are constructed with flat (recessed) plywood panels and composite core stiles/rails. Fairmont doors are available with a "Cove/Bead", "Mission" or "Prairie" Profile on 1 3/8" or 1 3/4" thick doors.

**FAIRMONT 1 3/8"**

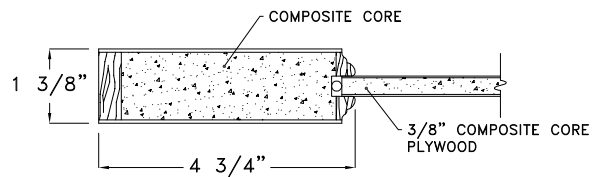

**FAIRMONT 1 3/4"**

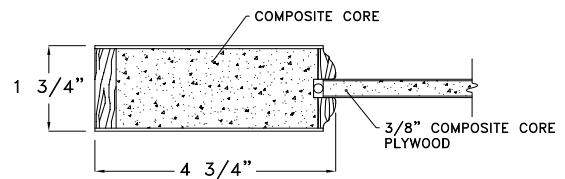

**GLASS:** Glass Doors are available with "Mission" Profile or "Cove/Bead" Profile. Glass doors include a series of door styles that are constructed with true divided lites and composite core stiles/rails. Glass Doors are available 1 3/8" or 1 3/4" thick.

**GLASS 1 3/8"**

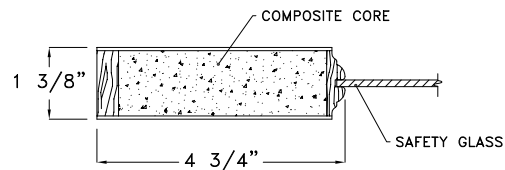

**GLASS 1 3/4"**

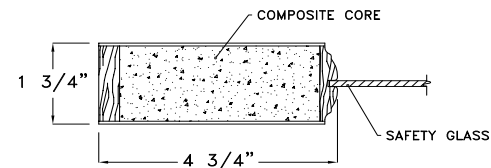

# General Information

## PROFILE OPTIONS

PrairieLake doors are available with a choice of "Profile Options". A Profile Option designates the decorative profile of the "sticking" (inside edge of the stile/rail) *and* the raised panel (if applicable). A Profile Option must be specified for Fairmont, Richmond and Glass door styles.

| COLLECTION | COVE & BEAD | MISSION | PRAIRIE |
|------------|-------------|---------|---------|
| Richmond   | ✓           | N/A     | N/A     |
| Fairmont   | ✓           | ✓       | ✓       |
| Glass Lite | ✓           | ✓       | N/A     |

## GLASS DOORS

Glass doors are available with the "Cove and Bead" Profile or "Mission" Profile.

### "COVE & BEAD" PROFILE

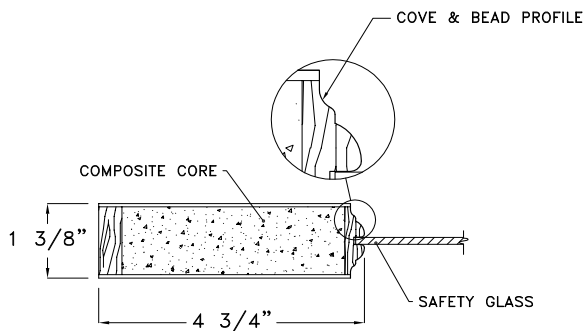

### "MISSION" PROFILE

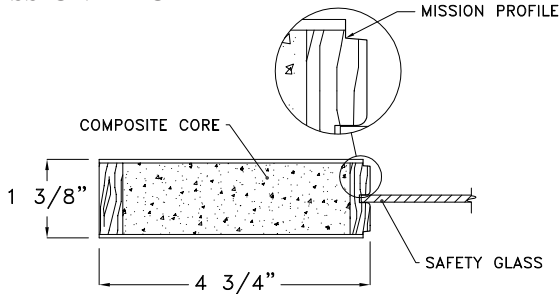

## RICHMOND DOORS

### "COVE & BEAD" PROFILE

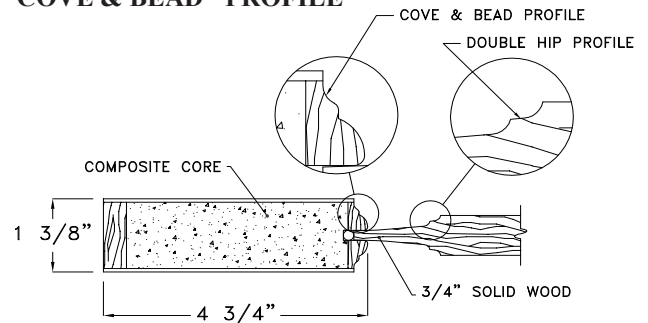

## FAIRMONT DOORS

### "COVE & BEAD" PROFILE

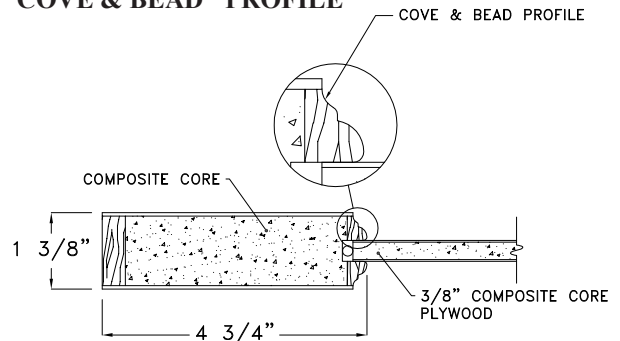

### "MISSION" PROFILE

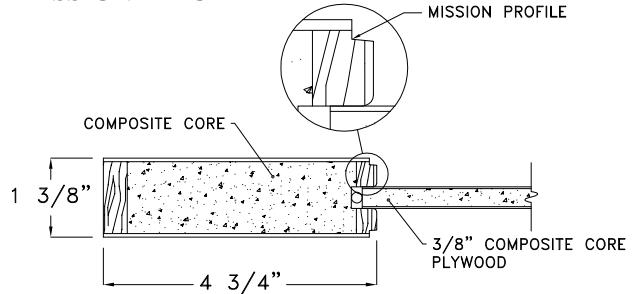

### "PRAIRIE" PROFILE

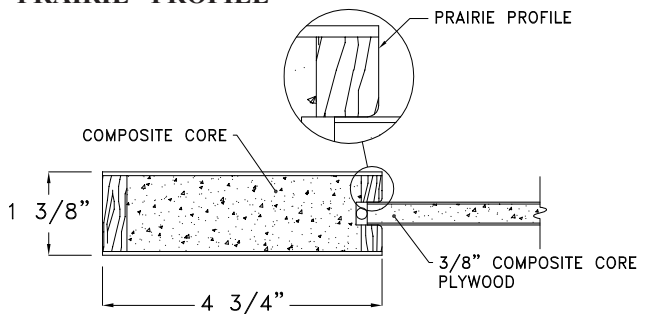

## DIMENSIONAL INFORMATION

PRAIRIELAKE® Interior Doors are available as "Slabs" (door only) or as "Pre-hung" units (hinged within a selected jamb).

Doors ordered as slabs (door only) must be specified as either "Pre-Fit" (sized, but not beveled, to fit within a jamb opening) or "Full & Square" (doors that are sent from the factory sized at full nominal width to be undersized, beveled and machined by the purchaser for hinging and hanging within a jamb). All "Full and Square" slabs are full nominal width and height. "Full and Square" Bi-Fold slabs are not available.

### PRE-FIT CLEARANCES:

Passage/Pocket: Full nominal in height  
 3/16" under nominal in width (3/32" off each side)  
 Double Door units have a 1/16" gap between doors

Bi-Fold Units: 1" under nominal in height (for hardware track clearance)  
 1/2" under nominal in OA width (2 door Bi-Folds)  
 1" under nominal in OA width (4 door Bi-Folds)

By-Pass Units: 1" under nominal in height (for hardware track clearance)  
 3/16" under nominal in width

\*1 3/4" thick Bi-Fold & By-Pass doors are sized 2" under nominal in height to accommodate heavy-duty track hardware.

\*\*Double Doors: The finished opening is 1/8" undersized (a 5/0 opening is actually 59 7/8" wide) to maintain a 1/16" gap between doors.

### ROUGH OPENINGS:

Typically, final measurements should be verified from rough, framed openings at the jobsite. Appropriate door sizes can then be determined from the rough openings.

For a typical passage door installation, a nominal door size should be ordered that is at least 2" smaller than the rough opening (RO) width. For a 32" RO, the largest possible door for that opening is 30" (2/6). This allows 30" for the door, 1 1/2" for the jamb thickness (3/4" thick jamb on both sides) and an additional 1/4" of shim space on both sides.

### ROUGH OPENING CHART

| ROUGH OPENING     | HEIGHT  | WIDTH                         |
|-------------------|---------|-------------------------------|
| 6/8 Passage Doors | 82"     | Add 2" to nominal door width  |
| 6/8 Pocket Doors  | 84 1/2" | (Nominal Door Width x 2) + 1" |
| 6/8 Bi-Fold Doors | 82"     | Add 2" to nominal door width  |
| 6/8 By-Pass Doors | 82"     | Add 1" to nominal door width  |

## DOWEL CONSTRUCTION

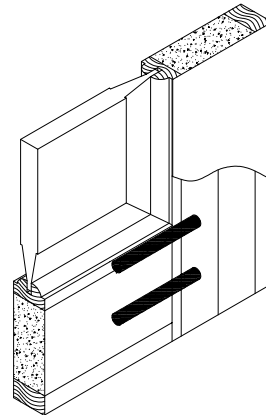

### "Dowels Make a Difference!"

PRAIRIELAKE® Interior Doors are crafted with true dowel construction for optimum strength and durability. A pair of 3 1/2" x 1/2" hardwood dowels are cold-glued to secure each joint. Lock rails and bottom rails are triple dowelled.

## DIMENSIONAL DIAGRAM

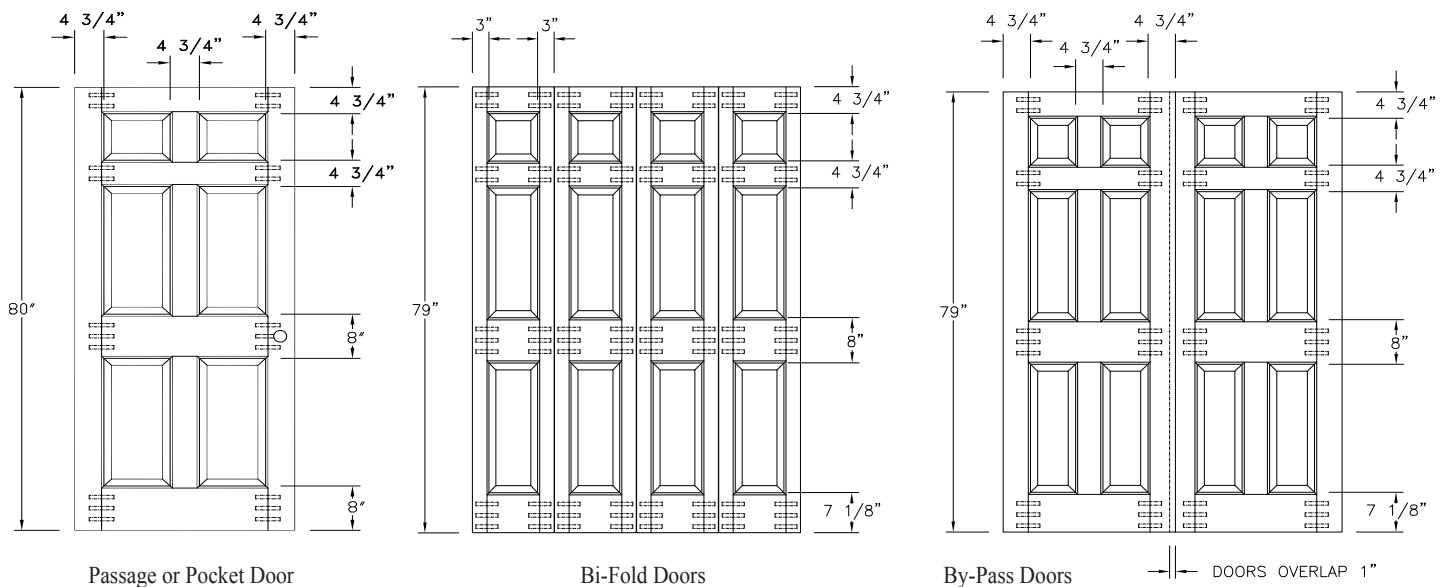

# General Information

## DOOR THICKNESS

Doors are available in either 1 3/8" thick or 1 3/4" thick applications based on personal preference.  
(Door thickness and components meet AWI specifications.)

### RAISED PANEL DOORS

1 3/8" thick doors are crafted with 3/4" thick panels.  
1 3/4" thick doors are available with either 3/4" thick center panels (Series A) or 1 1/8" thick panels (Series B).  
See page 28 for pricing.

### FLAT (RECESSED) PANEL DOORS

1 3/8" thick doors are crafted with 3/8" thick panels.  
1 3/4" thick doors are crafted with 3/8" thick panels.

Fire Rated doors are available 1 3/4" thick only with 1 1/4" thick raised panels or 3/4" thick flat panels. For specific dimensional information, see the FIRE RATED DOORS section.

## DIMENSIONAL OPTIONS

### DOOR HEIGHTS:

*When standard doors are increased in height (7/0 & 8/0), the overall number of panels do not increase.* For example, an R062 will still have 6 equally sized lites for a 6/8, 7/0 and 8/0 height.

*When standard doors are increased in height (7/0 & 8/0), specific panels of the door are affected.* If the door panels are all equally sized in height (i.e. R062), each panel increases in height proportionately. Otherwise, the tallest set of panels on the door is increased and the remaining panels stay the same (i.e. R041) See diagrams below.

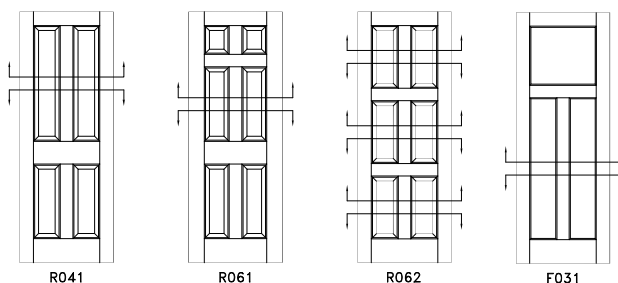

### DOOR WIDTHS:

To reduce the width of a door, start with the next larger standard size. For example, for a custom 2/3 wide door, start with a 2/4 door and add appropriate upcharge.

### CUSTOM HEIGHTS AND WIDTHS:

Custom heights and widths are available between standard sizes. Contact Customer Service for limitations. Additional lead times may apply. **NOTE:** Custom size components are not available. Only overall door size can be specified.

## ARCH OPTIONS

Richmond and Fairmont door styles are available with a variety of Arch options.

### ROMAN ARCH (20 SERIES)

Doors specified with a Roman Arch are designated as a "20 Series" arch on the order form. The door has a square (flat) top and the top panels are carved with a Roman Arch. A "Continuous Arch" option is available for 20 Series arch double doors, by-pass and double pocket doors at no charge. Specify "Continuous Arch 20 Series" in the "ARCH" column on the order form. (i.e. R042, 20 Series) (See page 23.)

### CATHEDRAL ARCH (30 SERIES)

Doors specified with a Cathedral Arch are designated as a "30 Series" arch on the order form. The door has a square (flat) top and the top panels are carved with a Cathedral Arch. (i.e. R042, 30 Series) (See page 23.)



## PRE-HUNG DOORS

### PRE-HUNG UNITS:

Doors can be pre-hung in jambs of your choice; fingerjointed (Pine), composite core, lumber core or solid wood.

(An appropriate jamb will be used based on the door type designation. i.e. Passage, Pocket, Bi-Fold, etc.)

Jamb legs are joined to the header with a rabbet joint. Jamb legs are sent 7/8" longer than the pre-hung door for jobsite trimming as needed. An applied stop molding is mitered at the header joint.

**FINGERJOINTED (Pine) JAMBS:** The most economical of the jamb offerings, Fingerjointed Jambs are a primed 11/16" thick Pine. A unique stop molding is used for all applications that is similar to "Colonial" Stop Molding. Refer to Flat Jamb Availability charts on p. 11.

**COMPOSITE CORE JAMBS:** Composite Jambs are 11/16" thick composite core with solid wood edge bands and a chosen wood species veneer. Composite Jambs are chosen for their quality and affordability. Refer to Flat Jamb Availability charts on p. 11.

**LUMBER CORE JAMBS:** Lumber Core Jambs are 11/16" thick lumber core with solid wood edge bands and a chosen wood species veneer. A less expensive version of a solid wood jamb, Lumber Core Jambs are chosen for their strength and durability. Refer to Flat Jamb Availability charts on p. 11.

**SOLID WOOD JAMBS:** Solid Wood Jambs are 3/4" thick solid wood to match the wood species of the door. All standard jamb widths and heights are available including custom specified widths. Refer to Flat Jamb Availability charts on p. 11.

**"STOP" MOLDING:** Standardly, jambs (with pre-hung doors) receive an applied Stop Molding that is mitered at the joints.

**CUSTOM WIDTH JAMBS:** Custom width jambs can be achieved as a starter jamb with an extension, or as a solid wood custom size 1 piece jamb.

**FLAT JAMB (PRE-HUNG) OPTIONS:** Minimum jamb width including stop is 3" for a 1 3/8" door and 3 3/8" for a 1 3/4" door. Jambs less than our minimum width will require jambs, stop and door to be shipped knocked down. Stop will need to be trimmed on jobsite. Custom width jambs are available in Solid Wood only.

## FLAT JAMBS

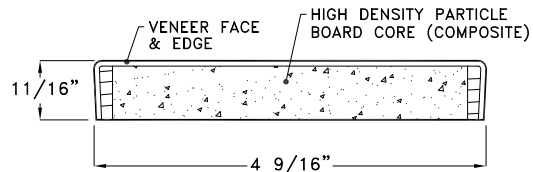

COMPOSITE CORE JAMB

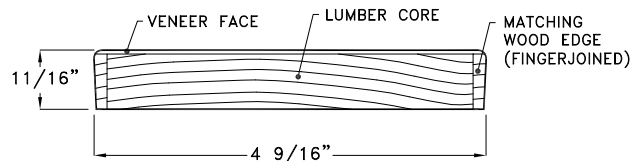

LUMBER CORE JAMB

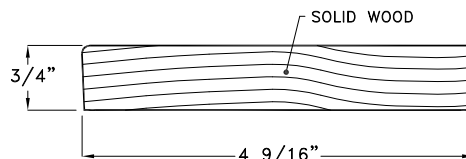

SOLID WOOD JAMB



COLONIAL STOP

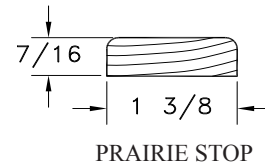

PRAIRIE STOP

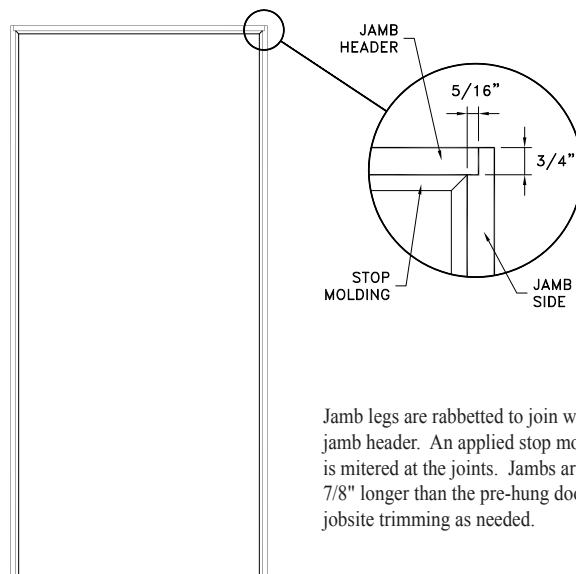

Jamb legs are rabbeted to join with the jamb header. An applied stop molding is mitered at the joints. Jambs are 7/8" longer than the pre-hung door for jobsite trimming as needed.

# General Information

## FINGERJOINTED (PINE), COMPOSITE, LUMBER CORE & SOLID WOOD FLAT JAMB AVAILABILITY CHART

| JAMBS         | Red Oak                         | Poplar | Cherry | Maple | Birch | Select/Knotty Alder |
|---------------|---------------------------------|--------|--------|-------|-------|---------------------|
| FINGERJOINTED | 4 5/8" x 6/8 (Pine Primed only) |        |        |       |       |                     |
|               | 4 5/8" x 7/0 (Pine Primed only) |        |        |       |       |                     |
|               | 4 5/8" x 8/0 (Pine Primed only) |        |        |       |       |                     |
|               | 4 7/8" x 6/8 (Pine Primed only) |        |        |       |       |                     |
|               | 4 7/8" x 7/0 (Pine Primed only) |        |        |       |       |                     |
|               | 4 7/8" x 8/0 (Pine Primed only) |        |        |       |       |                     |
| COMPOSITE     | 4 9/16" x 6/8                   | ✓      | ✓      | ✓     | ✓     | ✓                   |
|               | 4 9/16" x 7/0                   | ✓      | ✓      | ✓     | ✓     | ✓                   |
|               | 4 9/16" x 8/0                   | ✓      | ✓      | ✓     | ✓     | ✓                   |
|               | 4 13/16" x 6/8                  | ✓      | ✓      | ✓     | ✓     | ✓                   |
| LUMBER CORE   | 4 9/16" x 6/8                   | ✓      | ✓      | ✓     | ✓     | ✓                   |
|               | 4 9/16" x 7/0                   | ✓      | ✓      | ✓     | ✓     | ✓                   |
|               | 4 13/16" x 6/8                  | ✓      | ✓      | ✓     | ✓     | ✓                   |
|               | 6 9/16" x 6/8                   | ✓      | ✓      | ✓     | ✓     | ✓                   |
|               | 6 9/16" x 7/0                   | ✓      | ✓      | ✓     | ✓     | ✓                   |
| SOLID WOOD    | 4 9/16" x 6/8                   | ✓      | ✓      | ✓     | ✓     | ✓                   |
|               | 4 9/16" x 7/0                   | ✓      | ✓      | ✓     | ✓     | ✓                   |
|               | 4 9/16" x 8/0                   | ✓      | ✓      | ✓     | ✓     | ✓                   |
|               | 4 13/16" x 6/8                  | ✓      | ✓      | ✓     | ✓     | ✓                   |
|               | 4 13/16" x 7/0                  | ✓      | ✓      | ✓     | ✓     | ✓                   |
|               | 4 13/16" x 8/0                  | ✓      | ✓      | ✓     | ✓     | ✓                   |
|               | 5 1/4" x 6/8                    | ✓      | ✓      | ✓     | ✓     | ✓                   |
|               | 5 1/4" x 7/0                    | ✓      | ✓      | ✓     | ✓     | ✓                   |
|               | 5 1/4" x 8/0                    | ✓      | ✓      | ✓     | ✓     | ✓                   |
|               | 6 9/16" x 6/8                   | ✓      | ✓      | ✓     | ✓     | ✓                   |
|               | 6 9/16" x 7/0                   | ✓      | ✓      | ✓     | ✓     | ✓                   |
| 6 9/16" x 8/0 | ✓                               | ✓      | ✓      | ✓     | ✓     |                     |

\*Custom width jambs are available in solid wood only.

**STARTER AND EXTENSION JAMBS:** If a custom width jamb is required for a particular installation, order a "Starter Jamb" and then order the appropriate width of "Extension Jamb" to accommodate the wall thickness. Doors will be pre-hung in the Starter Jamb. The Extension Jamb is shipped loose and must be ripped to width on the jobsite and then installed in the Starter Jamb. Starter Jambs will be shipped knocked down on a double door unit to protect the integrity of the pre-hung unit. Available in solid wood. Refer to the Flat Jamb Options chart above.

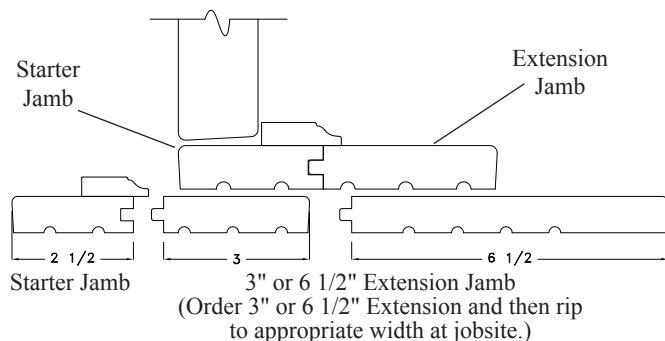

## ADDITIONAL JAMB OPTIONS

- In addition to our standard flat jambs (available as fingerjointed Composite, Lumber Core or Solid Wood) Woodharbor also manufactures Rabbetted Jambs and T-Stop Jambs. Although these jambs are typically used with our Fire Rated Doors, they can also be specified for standard non-rated applications.

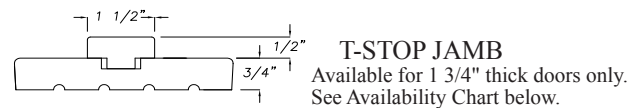
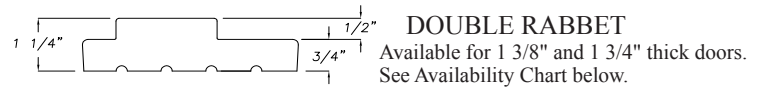
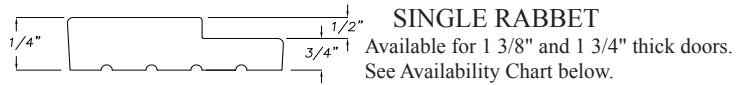

- Contact Customer Service for custom Rabbet or T-Stop Jamb width modifications. See Jamb Availability Chart below.

## T-STOP & RABBETTED JAMBS JAMB AVAILABILITY CHART

| JAMBS                | Red Oak  | Poplar | Cherry | Maple | Birch |
|----------------------|----------|--------|--------|-------|-------|
| T-STOP FOR 3/4" ONLY | 4 9/16"  | ✓      | ✓      | ✓     | ✓     |
|                      | 4 13/16" | ✓      | ✓      | ✓     | ✓     |
|                      | 6 9/16"  | ✓      | ✓      | ✓     | ✓     |
|                      | 6 11/16" | ✓      | ✓      | ✓     | ✓     |
|                      | 6 13/16" | ✓      | ✓      | ✓     | ✓     |
| SINGLE RABBET        | 4 9/16"  | ✓      | ✓      | ✓     | ✓     |
|                      | 4 13/16" | ✓      | ✓      | ✓     | ✓     |
|                      | 6 9/16"  | ✓      | ✓      | ✓     | ✓     |
|                      | 6 13/16" | ✓      | ✓      | ✓     | ✓     |
| DOUBLE RABBET        | 4 9/16"  | ✓      | ✓      | ✓     | ✓     |
|                      | 4 13/16" | ✓      | ✓      | ✓     | ✓     |
|                      | 6 9/16"  | ✓      | ✓      | ✓     | ✓     |
|                      | 6 11/16" | ✓      | ✓      | ✓     | ✓     |
|                      | 6 13/16" | ✓      | ✓      | ✓     | ✓     |

\*Jambs are available up to 8/0 height.

**KERFED JAMBS (DRY WALL KERF):** 1/8" wide and 1/2" deep saw cut down the center of both edges of solid stock creates the kerf. A metal corner bead is placed into the sawn groove and extends over the sheet rock to make the jamb edge and sheet rock flush with each other. This is typically used when not installing any casing to the outside of the jamb.

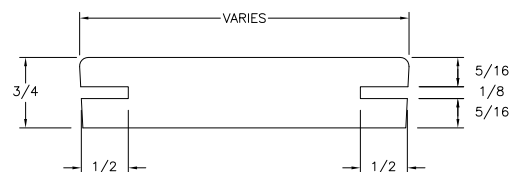

## HANDING

**"HANDING":** Door "handing" refers to the swing of the door. Please refer to the diagrams for door handing/swing. Some suppliers use different terminology to specify door handing, so it is of utmost importance to verify your specification with the diagrams below and at right.

All Pre-hung Passage doors must be specified as "Left-Hand" or "Right-Hand" to designate hinging and the swing of the door. Strictly speaking, the door itself is either "Right-Hand" or "Left-Hand". However, when lock applications require that one side of the door be machined differently than the other, "Reverse Handing" becomes important. (See below.)

Pre-Hung Double Doors utilize a "handing" designation to specify the "Active" door. Flush bolts and T-Astragals are installed on the "inactive" door.

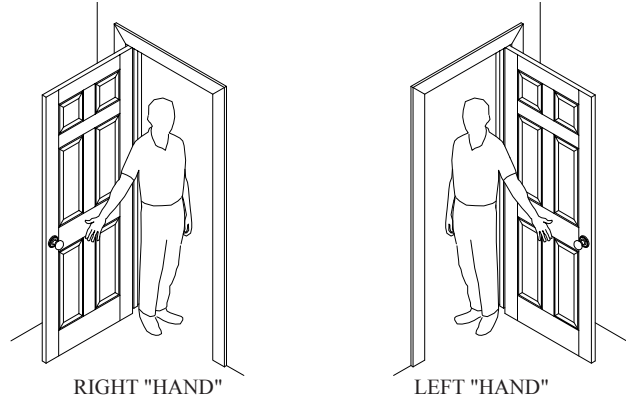

Refer to the diagram below to specify "handing" of a pre-hung door. Another simple way to remember how to specify "handing" is the "butt to butt" method. Stand with your back (or "butt") to the "butt" of the hinges (see above) and use your left or right hand to indicate the swing of the door. (For doors with lockset machining, see "Reverse Handing" designations below.)

## "HANDING" DIAGRAM

SINGLE DOORS

DOUBLE DOORS

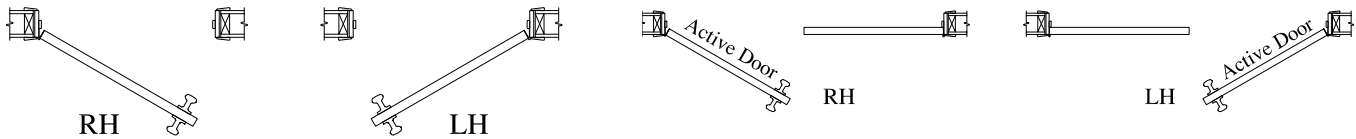

**"HANDING" DOORS WITH LOCKSET MACHINING:** In order to correctly "hand" a door that has a lock application (more specifically, a door that requires machining that is different on one side than the other), you first have to identify which side of the opening is the secure (or keyed) side - this is referred to as the "outside" of the door. For example, in a hotel corridor, each door would be keyed from the corridor - this is the secure side or the "outside" of the door.

There are four possible directions of door swings to consider when determining the "hand" of an opening with lock applications: "Left Hand" (LH), "Right Hand" (RH), "Left Hand Reverse" (LHR), and "Right Hand Reverse" (RHR). Refer to the diagram below to specify "handing" of a pre-hung door with machining for locking hardware. To specify handing, always stand in the corridor or on the keyed side of the opening. If the door swings into the room (away from you) use "Right-Hand" or "Left-Hand" designations. If the door swings into the corridor (or toward you) use "Right-Hand Reverse" or "Left-Hand Reverse" designations. (See below.)

## "HANDING" DIAGRAM FOR DOORS WITH LOCKSET MACHINING

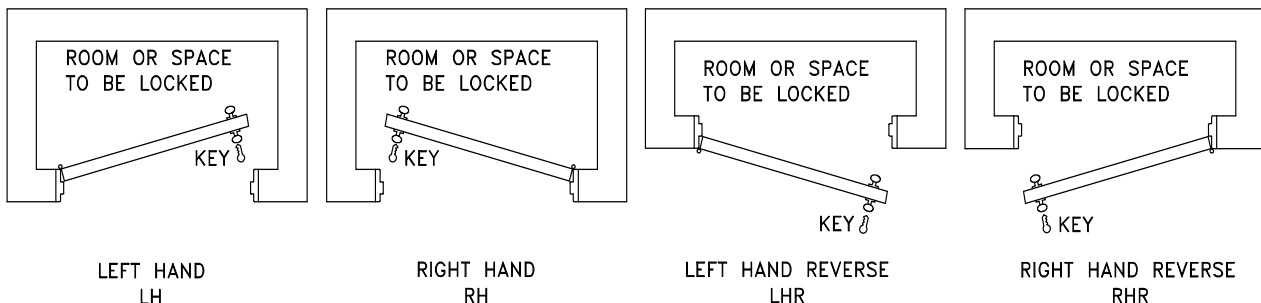

# General Information

## DOOR BEVEL

All Pre-Hung Passage Doors and Double Doors have a 3° bevel on the swing side of the door to accommodate complete closure of the door even during periods of higher than average humidity. The door is beveled based on the "handing" designation.

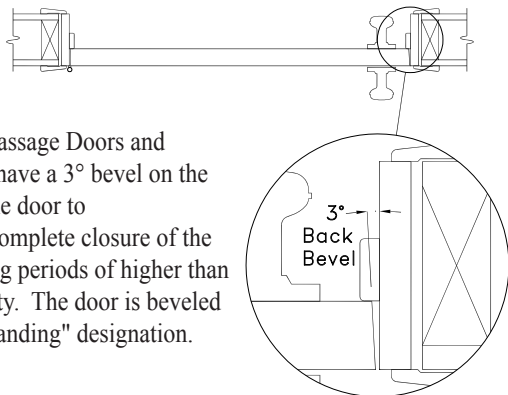

For Pre-Hung Double Doors, both doors are back beveled which results in a slightly larger gap on the "stop side" of the doors in comparison to the "hinge side".

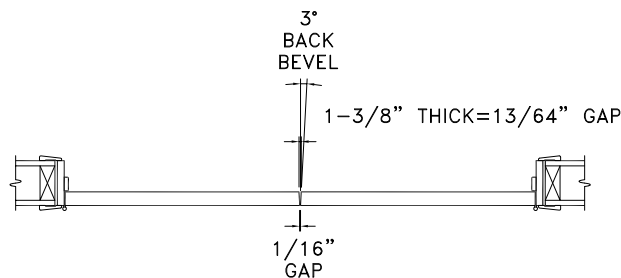

## DOUBLE DOORS

Double Doors are always specified by the overall size of the opening. (i.e. 5/0 Double, 4/0 Double). Double doors include 2 doors that can be specified as "Doors Only" or as a Pre-Hung unit within a single jamb. Each pre-hung door is hinged and often times, additional hardware (astragal with flush bolts, ball catches, etc.) is specified.

The finished opening of a pre-hung Double Door unit is 1/8" undersized (a 5/0 opening is actually 59 7/8" wide) to maintain a 1/16" gap between doors. (An additional 1/16" of shimming is required on each side for proper installation.)

## T-ASTRAGAL

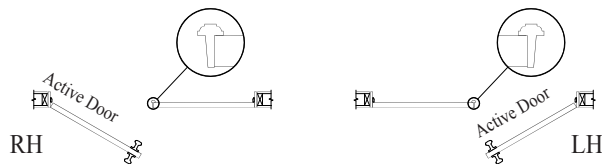

A T-Astragal is specified to cover the reveal (or gap) between doors. When a T-Astragal is specified, the stile receiving the astragal is trimmed 7/16" to accommodate the astragal. Astragals are installed on the inactive door based on the "handing" designation. If Flush Bolts are specified with a T-Astragal, they are mortised into the Astragal.

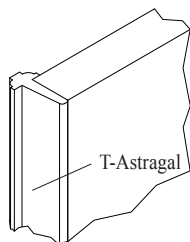

## BALL CATCHES

Ball catches are used to secure a door or doors within an opening without actually locking the door(s). **Ball Catches are available in Polished Brass, Antique Brass, Polished Chrome, Satin Chrome, Antique Nickel, Satin Nickel and Oil Rubbed finish options** to match the hinges. When a Ball Catch is specified, the top of the door is mortised and the Ball Catch is installed at the factory. Strike Plates are mortised and installed into jambs.

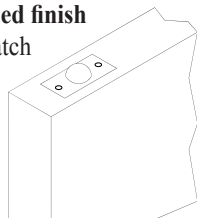

## FLUSH BOLTS

Flush Bolts are specified for Double Doors only when the doors need to be secured or locked. A Flush Bolt is mortised into the edge of the door for a flush application. (Surface mounted bolts can be installed on the jobsite.) A Flush Bolt secures one door within the jamb so that the other door can be machined for a lockset.

When Flush Bolts are specified, the door is mortised and the Flush Bolts are installed at the factory. Strike plates are mortised and installed into jambs.

Several different Flush Bolt options are available based on personal preference and/or the height of the door. For 6/8 or 7/0 height doors, a standard 6" Manual Flush Bolt can be installed as a Head Bolt (at the top of the door) or as a Foot Bolt (at the bottom of the door) or in both locations (Head & Foot Bolt). If not specified on the order, a Head & Foot Bolt are supplied. For 8/0 height doors, an Extension Bolt is recommended for the Head Bolt while a standard Manual Flush Bolt can be used at the Foot Bolt.

**Flush bolts are available in Polished Brass, Antique Brass, Polished Chrome, Satin Chrome, Antique Nickel, Satin Nickel and Oil Rubbed finish options.** (Flush Bolts are not stocked in Satin Brass or Antique Bronze finishes. For a close match, specify Polished Brass to blend with Satin Brass hinges and specify Antique Brass to blend with Antique Bronze hinges.)

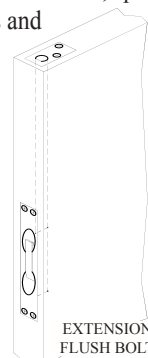
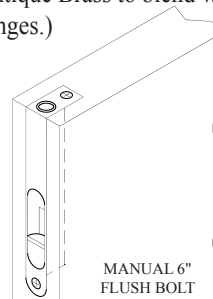

## HINGING

**HINGES:** Doors that are ordered pre-hung will include PBB architectural grade hinges as specified from our standard selection (plain bearing, 5 knuckle, butt hinges). An optional Ball Bearing (BB) Hinge is available. Hinges are available in a choice of finish options. See Hinge Finish Availability chart below. Specify finish clearly on your order form. **Satin Brass or Polished Brass hinges can be specified at no charge.** Other in-stock finishes are available for an upcharge. To specify hinges that are not listed within the standard offering, please call for availability.

- ◆ 1 3/8" thick doors are hung with 3 1/2" x 3 1/2" hinges with 5/8" radius corners.
- ◆ 1 3/8" thick doors offer Plain Bearing Hinges standardly. An optional Ball Bearing hinge is available.

### 1 3/8" THICK HINGE OPTIONS:

#### PLAIN BEARING HINGE FINISHES

| H1 (3 1/2" x 3 1/2") Hinges<br>5/8" radius corners (Plain Bearing) |
|--|
| H1-PB (Polished Brass) US3   |
| H1-SB (Satin Brass) US4  |
| H1-AB (Antique Brass) US5  |
| H1-PC (Polished Chrome) US26                                       |
| H1-SC (Satin Chrome) US26D   |
| H1-ABZ (Antique Bronze) US10A                                      |
| H1-AN (Antique Nickel) US15A                                       |
| H1-SN (Satin Nickel) US15  |
| H1-BC (Black Coated) 800   |
| H1-OR (Oil Rubbed Finish) US10B                                    |

#### BALL BEARING HINGE FINISHES

| H1 (3 1/2" x 3 1/2") Hinges<br>5/8" radius corners (Ball Bearing) |
|---|
| H1BB-PB (Polished Brass) US3                                      |
| H1BB-SB (Satin Brass) US4   |
| H1BB-AB (Antique Brass) US5                                       |
| H1BB-PC (Polished Chrome) US26                                    |
| H1BB-SC (Satin Chrome) US26D                                      |
| H1BB-ABZ (Antique Bronze) US10A                                   |
| H1BB-AN (Antique Nickel) US15A                                    |
| H1BB-SN (Satin Nickel) US15                                       |
| H1BB-BC (Black Coated) 800  |
| H1BB-OR (Oil Rubbed Finish) US10B                                 |

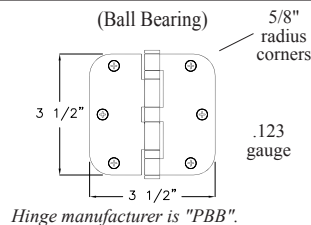
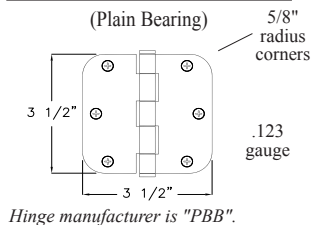

- ◆ 1 3/4" thick doors are hung with 4" x 4" hinges with 1/4" radius corners.
- ◆ 1 3/4" thick doors offer Plain Bearing Hinges standardly. An optional Ball Bearing Hinge is available.

### 1 3/4" THICK HINGE OPTIONS:

#### PLAIN BEARING HINGE FINISHES

| H3 (4" x 4") 1 3/4" Thick Doors<br>1/4" Radius Corners (Plain Bearing) |
|--|
| H3-PB (Polished Brass) US3   |
| H3-SB (Satin Brass) US4  |
| H3-AB (Antique Brass) US5  |
| H3-PC (Polished Chrome) US26   |
| H3-SC (Satin Chrome) US26D   |
| H3-ABZ (Antique Bronze) US10A  |
| H3-AN (Antique Nickel) US15A   |
| H3-SN (Satin Nickel) US15  |
| H3-BC (Black Coated) 800   |
| H3-OR (Oil Rubbed Finish) US10B  |

#### BALL BEARING HINGE FINISHES

| H3 (4" x 4") 1 3/4" Thick Doors<br>1/4" Radius Corners (Ball Bearing) |
|---|
| H3BB-PB (Polished Brass) US3  |
| H3BB-SB (Satin Brass) US4   |
| H3BB-AB (Antique Brass) US5   |
| H3BB-PC (Polished Chrome) US26  |
| H3BB-SC (Satin Chrome) US26D  |
| H3BB-ABZ (Antique Bronze) US10A                                       |
| H3BB-AN (Antique Nickel) US15A  |
| H3BB-SN (Satin Nickel) US15   |
| H3BB-BC (Black Coated) 800  |
| H3BB-OR (Oil Rubbed Finish) US10B                                     |

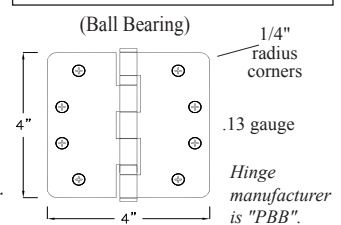
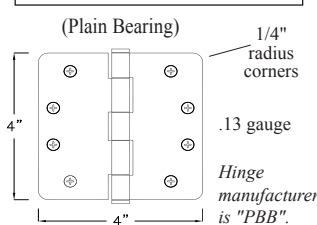

- ◆ Square Corner Hinges are also available in a choice of finish options. Specify clearly on your order form.

### 1 3/8" SQUARE CORNER HINGE FINISH CHART

| H1 (3 1/2" x 3 1/2")<br>Square Corners 1 3/8" Thick Doors<br>(Plain Bearing) | H1 (3 1/2" x 3 1/2")<br>Square Corners 1 3/8" Thick Doors<br>(Ball Bearing) |
|--|---|
| H1SQ-PB (Polished Brass) US3   | H1BBSQ-PB (Polished Brass) US3  |
| H1SQ-SB (Satin Brass) US4  | H1BBSQ-SB (Satin Brass) US4   |
| H1SQ-AB (Antique Brass) US5  | H1BBSQ-AB (Antique Brass) US5   |
| H1SQ-ABZ (Ant. Bronze) US10A   | H1BBSQ-ABZ (Ant. Bronze) US10A  |
| H1SQ-SN (Satin Nickel) US15  | H1BBSQ-SN (Satin Nickel) US15   |
| H1SQ-AN (Antique Nickel) US15A   | H1BBSQ-AN (Antique Nickel) US15A  |
| H1SQ-PC (Polished Chrome) US26   | H1BBSQ-PC (Polished Chrome) US26  |
| H1SQ-SC (Satin Chrome) US26D   | H1BBSQ-SC (Satin Chrome) US26D  |
| H1SQ-BC (Black Coated) 800   | H1BBSQ-BC (Black Coated) 800  |
| H1SQ-OR (Oil Rubbed Finish) US10B  | H1BBSQ-OR (Oil Rubbed Finish) US10B   |

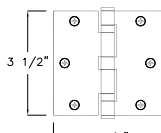
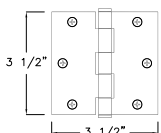

### 1 3/4" SQ. CORNER HINGE FINISH CHART

| H3 (4" x 4")<br>Square Corners 1 3/4" Thick Doors<br>(Plain Bearing) | H3 (4" x 4")<br>Square Corners 1 3/4" Thick Doors<br>(Ball Bearing) |
|--|---|
| H3SQ-PB (Polished Brass) US3   | H3BBSQ-PB (Polished Brass) US3                                      |
| H3SQ-SB (Satin Brass) US4  | H3BBSQ-SB (Satin Brass) US4   |
| H3SQ-AB (Antique Brass) US5  | H3BBSQ-AB (Antique Brass) US5                                       |
| H3SQ-ABZ (Antique Bronze) US10A                                      | H3BBSQ-ABZ (Antique Bronze) US10A                                   |
| H3SQ-SN (Satin Nickel) US15  | H3BBSQ-SN (Satin Nickel) US15                                       |
| H3SQ-AN (Antique Nickel) US15A                                       | H3BBSQ-AN (Antique Nickel) US15A                                    |
| H3SQ-PC (Polished Chrome) US26                                       | H3BBSQ-PC (Polished Chrome) US26                                    |
| H3SQ-SC (Satin Chrome) US26D   | H3BBSQ-SC (Satin Chrome) US26D                                      |
| H3SQ-BC (Black Coated) 800   | H3BBSQ-BC (Black Coated) 800  |
| H3SQ-OR (Oil Rubbed Finish) US10B                                    | H3BBSQ-OR (Oil Rubbed Finish) US10B                                 |

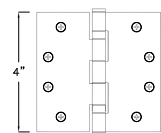
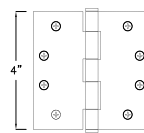

# General Information

## CUSTOM HINGE OPTIONS

- ♦ To specify a hinge that is *not* within Woodharbor's standard hinge offering, contact Customer Service for availability, specifications and pricing. Custom hinge options can be ordered by Woodharbor or "Customer Supplied" hinges can be supplied to Woodharbor for pre-hanging. (A "handling fee" is applied to coordinate "customer supplied" hinges.)
- ♦ Specifying custom hinges (hinges that are not within Woodharbor's standard offering) involves many variables that must be thoroughly verified before an order enters production. (Gauge/thickness, screw hole locations, radius corners, size, etc.) Contact Customer Service for complete information and procedures.
- ♦ If Woodharbor will be machining doors at the factory for jobsite installed hinges, it is best to supply 3 hinges to Woodharbor for verification of the specs/template. Please provide a current hinge template (from the hinge manufacturer). Woodharbor will machine according to the manufacturer's specs/templates but a fit is not guaranteed unless 3 hinges are supplied for verification.

## CUSTOMER SUPPLIED HINGES:

- ♦ For "Customer-Supplied" hinges, a sample of the hinge must be supplied to Woodharbor for prior approval. All hinges for the job must be received at Woodharbor before the order is released into production and given a scheduled delivery date.

***A "Customer-Supplied Product Form" must accompany the shipment. See Order Form Templates section.***

Note: Any customer supplied hardware that we Pre-hang will have the hinge mortises machined  $1/32$ " over the hinge size to accommodate variance often found within other hinges you supply Woodharbor, i.e.,  $3\ 1/2$ " x  $3\ 1/2$ " hinges will be mortised at  $3\ 17/32$ ". The hinge will be centered in this mortise though variances in the hinge size may reveal a gap between the hinge and mortise of up to and including  $1/64$ " at the top and bottom. Within a job you may experience a variance as described, to a tight fit. This variance is to be expected and is not a cause for replacement. (See diagram on right.)

- ♦ If Woodharbor is unable to utilize the screws supplied with the hinges (due to length, incompatibility, etc.), Woodharbor will use standard in-house screws and return the original screws for jobsite installation.
- ♦ If "Customer Supplied" hinges require application of *hinge tips* at the factory, an additional upcharge will be applied.

## "OIL RUBBED" HINGES:

- ♦ When an "Oil-Rubbed" hinge finish (US10B) from a manufacturer other than PBB is requested on a  $1\ 3/8$ " or  $1\ 3/4$ " thick door, Woodharbor will pre-hang the doors with our standard hinge. Woodharbor cannot handle "Oil-Rubbed" hinges at the factory because the oil residue will stain any unfinished wood on your job and subsequent jobs being processed). Please contact Customer Service for specific information.

## MISCELLANEOUS OPTIONS

**DOUBLE ACTING HINGE:** A "Double Acting Hinge" can be specified for doors that need to swing both directions. The door receives a "bullnose" on both edges and is mortised for the hardware. Hardware is shipped loose for field installation. Two face plates and a heel plate are included to conceal the operating hardware. (A decorative, hand push-plate can be sourced locally if desired.)

**Double Acting Hinges are available in Polished Brass, Satin Brass, Antique Brass, Polished Chrome, Satin Chrome, Antique Bronze, Antique Nickel, Satin Nickel and Oil Rubbed finish options.**

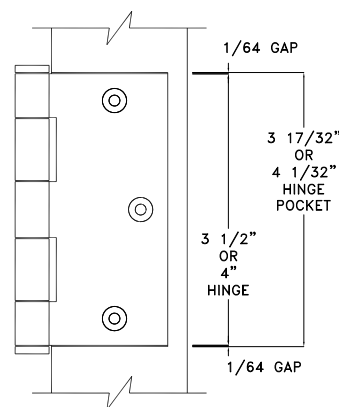
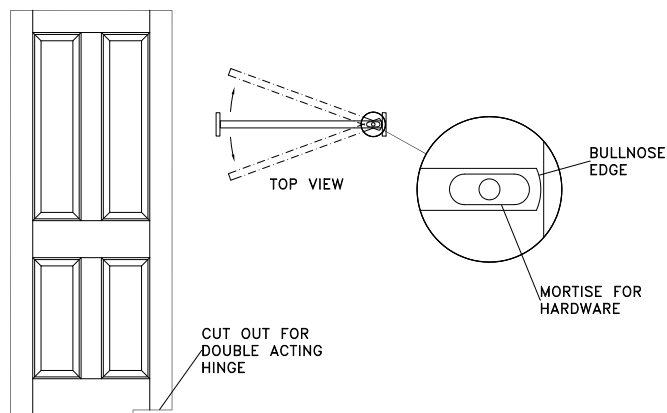

## HINGE LOCATIONS

### 1 3/8" THICK DOORS (3 1/2" X 3 1/2" HINGES)

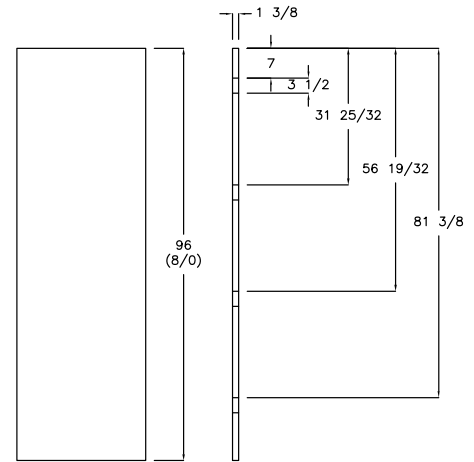
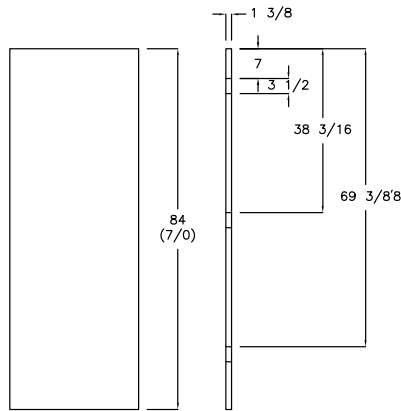
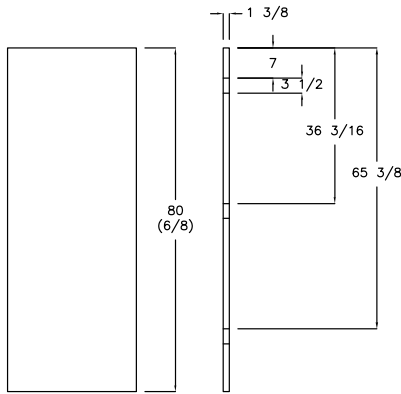

### 1 3/4" THICK DOORS (4" X 4" HINGES)

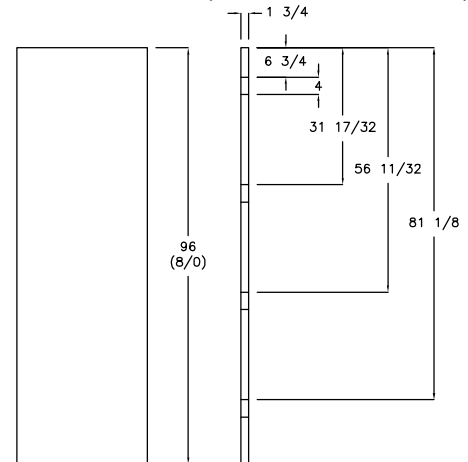
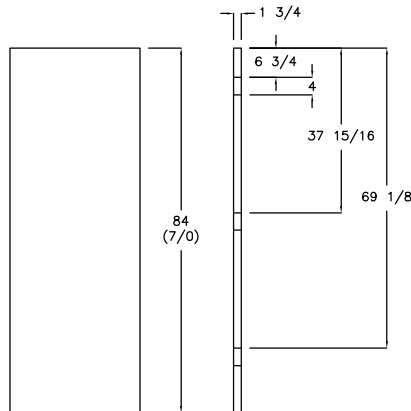
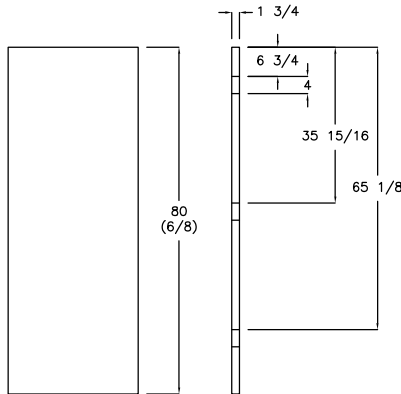

Standard hinge locations for 6/8, 7/0 and 8/0 doors are shown above for both 1 3/8" and 1 3/4" thick doors. (Woodharbor will also machine for hinges for standard Hollow Metal/Aluminum jamb locations.) Custom hinges locations are available.

- ♦ **Decorative Tips are available in Polished Brass and Oil Rubbed** (sent loose for jobsite installation). Hinge tips are available in a variety of designs (see diagram to the lower left).
- ♦ For other finishes, contact Customer Service for availability, lead times and pricing.

## DECORATIVE HINGE TIPS

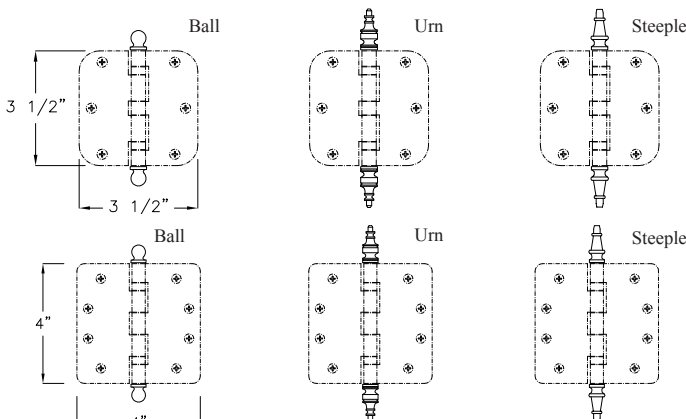

### DECORATIVE HINGE TIPS

#### H1 (3 1/2" x 3 1/2")

- H1-TIPB-PB (Ball) (Polished Brass) US3
- H1-TIPB-OR (Ball) (Oil Rubbed) US10B
- H1-TIPU-PB (Urn) (Polished Brass) US3
- H1-TIPU-OR (Urn) (Oil Rubbed) US10B
- H1-TIPS-PB (Steeple) (Polished Brass) US3
- H1-TIPS-OR (Steeple) (Oil Rubbed) US10B

#### H3 (4" x 4")

- H3-TIPB-PB (Ball) (Polished Brass) US3
- H3-TIPB-OR (Ball) (Oil Rubbed) US10B
- H3-TIPU-PB (Urn) (Polished Brass) US3
- H3-TIPU-OR (Urn) (Oil Rubbed) US10B
- H3-TIPS-PB (Steeple) (Polished Brass) US3
- H3-TIPS-OR (Steeple) (Oil Rubbed) US10B

# General Information

## MACHINING (Standard)

### STANDARD FACE BORE:

Pre-hung doors are bored with a standard 2 1/8" face bore. The face bore is located approximately 35" from the bottom of the door. Doors with 3" stiles and no lock rail (i.e. R062, 1/0 passage) are not available with a face bore. A ball catch and a dummy knob are recommended.

### EDGE PREP:

The edge has a 1" bore and is mortised (1/4" radius corners) for a 1" x 2 1/4" latch face plate. Square corners are available for an upcharge. A "Drive-In" edge prep is also available at no charge with a standard 1" edge bore and no mortise.

### BACKSET:

"Backset" is the distance from the edge of the door to the center of the Face Bore. Standard backset is 2 3/8". A 2 3/4" backset is available as a no charge option upon request.

### HINGES:

See pages 14 - 16 for standard hinge machining and locations.

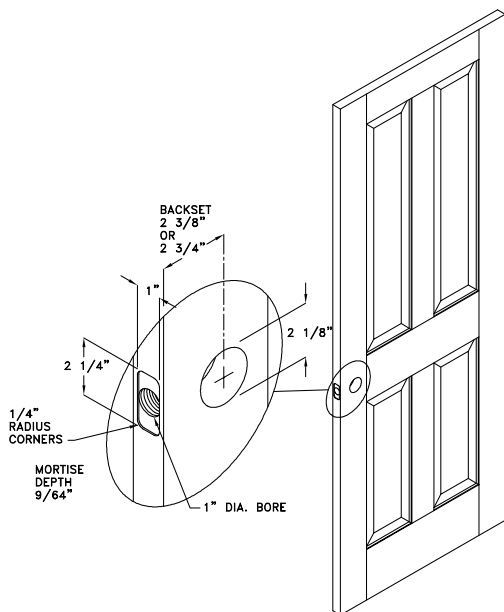

Doors specified without a jamb (Door Only) are not beveled or machined for hinges or latchsets unless requested. Upon request, standard machining can be done at no charge. Custom Machining of door slabs are available.

### STRIKES:

The jamb is mortised to accept strike plates. Our standard mortise is for a Full Lip Strike. An optional T-Strike mortise can be specified at no additional charge. Square corner available for an upcharge.

#### Full Lip Strike:

1 3/8" Doors = 1 1/4" x 2 1/4" x 3/64" deep with 1/4" radius corners  
 1 3/4" Doors = 1 7/16" x 2 1/4" x 3/64" deep with 1/4" radius corners

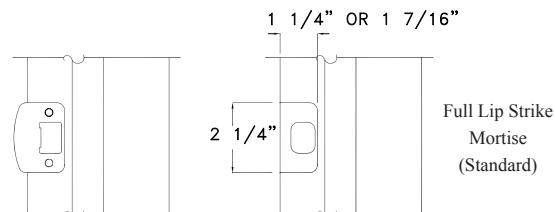

#### T-Strike:

1 1/8" x 2 3/4" x 1/16" deep with 1/4" radius corners

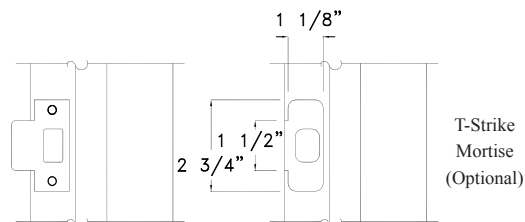

## MACHINING (Custom)

If any variation from "Standard Machining" is required (face bore size, face bore location, hinge locations, etc.) use Custom Machining pricing and specify all machining requirements on the Machining Template Order Form. Always specify Manufacturer's Brand name and Template number where available.

When custom machining is required, please complete a "Machining Template Order Form" (See Order Form Template Section) and carefully specify all machining requirements. If Templates are available from the manufacturer, please include them with your order. Also, if a sample of the hinge, mortise box, etc. is sent to the factory, we will verify a fit.

## EFFECTS OF MOISTURE IN WOOD

Under normal conditions, all wood products contain some moisture. Wood is a hygroscopic material and it readily exchanges moisture with the environment. This is true of ALL wood products, whether they are raw or finished. Although a finish will slow this process, wood will regardless react to changes in humidity.

When humidity conditions are high, wood will absorb moisture and swell (or expand). In low humidity conditions, wood will release moisture and shrink (or contract). Wood will not change size or shape unless its moisture content changes due to humidity conditions of the environment. (In response to high humidity, wood primarily changes in width and thickness.)

As *normal minor* fluctuations in humidity occur, the dimensional response of the wood will be insignificant. To avoid problems, it is recommended that relative humidity be maintained within a range of 40% - 50%. Uncontrolled extremes (above 80% or below 20%) are likely to cause problems. Wood products perform successfully, as they have for centuries, when correctly used within a proper environment. Problems associated with dimensional change are usually the result of improper humidity conditions during site storage, installation or use.

### **Points to consider:**

- ♦ The density of the wood can affect how much or how little it reacts to changes in humidity. More dense species (Maple) will expand or contract more than "softer" species like Cherry.
- ♦ Effects of extreme moisture or dryness may include panel expansion/contraction, joint separation, veneer checking or cracking, bowing of the stile or rail and/or expansion/contraction of the stile/rail.
- ♦ Wood products located in humid climates are especially susceptible to expansion due to moisture. If the door has been exposed to excessive moisture, the top and/or bottom rails can expand and extend beyond the stiles. Product failure due to high moisture conditions is not covered under the warranty. Such locations include waterfront properties and coastal regions without properly maintained humidity conditions.
- ♦ Regardless of location, products installed in non-air conditioned homes are especially susceptible to moisture concerns. Winter and vacation homes should maintain some form of climate control even during off season.

## EFFECTS OF MOISTURE *continued ...*

- ♦ Because doors are installed within a jamb, excessive expansion can cause the doors to bind or rub against the jamb. Upon activation of proper climate control, doors should resume their original dimension over time. (*Please note that if doors are exposed to excessive moisture for an extended period of time, they may not resume their original dimension.*) For this reason, trimming or "shaving" the door edges is not recommended. If a door needs to be trimmed for fitting purposes, the edges must be sealed immediately. Also, care should be taken to control humidity conditions even during storage and installation.
- ♦ Doors that are to be painted will reveal "seams" at the joints as natural wood movement occurs. These seams are unavoidable and are a natural characteristic of a painted finish on wood.
- ♦ Doors should be completely finished on both faces and all four edges as soon as possible. (See Handling, Installation and Finishing Instructions.) Finishing/sealing the door will minimize and slow the absorption of moisture but it will not eliminate it, so proper humidity levels are important throughout storage, installation and use.

Please note that great care is taken when selecting properly kiln dried woods with a 5% - 8% moisture content to ensure stability in climate controlled homes. With proper maintenance of humidity levels (normal fluctuations are expected but uncontrolled extremes are likely to cause problems) your PRAIRIELAKE Interior Doors will perform reliably and beautifully. Please note that the warranty does not cover product concerns related to improper humidity/moisture levels.

# General Information

## WOOD SPECIES

Wood interior doors have a unique character all their own. Each piece of wood, each cut of veneer is entirely unique - just as no two trees are exactly alike. Soil and climatic conditions affect the growth characteristics, grain and coloring of wood and the finest of hardwoods will display mineral streaks, gum spots and knots. *These natural variations (color variation, grain patterns, worm tracks, pin knots, mineral streaks, etc.) are part of the natural beauty, character and appeal of wood and should be carefully reviewed with your customers.*

Great care is used in selecting quality, kiln-dried hardwoods for your interior doors. A 5-8% moisture content ensures that your doors remain stable in most environments. However, wood, by its very nature, will expand during humid summer months and shrink during dry winter months. Therefore, humidity levels in your home should be carefully monitored and maintained at 40-50% during installation and throughout the year to maintain the appropriate moisture content. Uncontrolled extremes - below 20% or above 80% - are likely to cause problems.

**RED OAK (Rotary/Plain Sliced):** Oak hardwoods are chosen for their prominent and beautiful, open grain patterns varying from a close-knit vertical grain to a characteristic "cathedral" or arched pattern. Some color variation from reddish tan to medium brown is possible in its natural state. Occasional pin knots and mineral streaks are also characteristic. Red Oak is an abundant, strong and heavy hardwood with high shock resistance.

**POPLAR:** Poplar is a smooth, fine-grained hardwood that is mostly light in color but with dramatic color variation. Streaks of green, yellow and gray are common. Poplar is relatively light in weight with average shock resistance. *(Although Poplar is relatively smooth in texture, it will exhibit more grain telegraphing or texture in comparison to Maple.)*

**MAPLE (Hard):** Maple hardwoods are selected for their smooth texture, uniform grain and characteristic light color. Maple is predominantly a creamy white color and may exhibit little color variation from white to a light gray or tan. Maple will exhibit random mineral streaks. These dark streaks are mineral deposits absorbed from the soil in which the tree grew and are a naturally occurring variation. "Worm tracks" and occasional "birds-eye" patterns are also characteristic. Maple will slightly mellow with age due to natural exposure to light and air. Due to the density and hardness of Maple, natural expansion and contraction may be more apparent at joints than with softer hardwoods. Maple is a hard, strong wood with excellent shock resistance.

**BIRCH:** Natural Yellow Birch hardwoods are chosen for their *dramatic color variation* and usually smooth grain. Birch hardwoods will exhibit *dramatic* color variation from a creamy color to a medium brown. Characteristics such as shiny burl wood, grain variation, small pin knots and mineral stains may also be present. *Birch should not be chosen as an alternative to Maple* - although the two wood species may sometimes be similar in texture, Birch hardwoods will exhibit dramatic color and shade variation. Although Birch is relatively light in weight, it is hard and strong with excellent shock resistance.

## WOOD SPECIES

*continued ...*

**CHERRY:** Cherry hardwoods are chosen for their smooth texture, rich color and flowing grain patterns. In its natural state, cherry has a predominantly pinkish hue and may range in color from nearly white to pink to dark brown. (Due to these characteristic areas of light sapwood, Cherry is not recommended with a "Natural" finish. Even a light colored stain will blend and temper this color variation.) Some selections can even exhibit shades of yellow, green and gray. Small gum spots, "pin" holes, pitch pockets and mineral flecks are characteristic. Cherry will darken (mellow) with age due to exposure to sunlight - this color change can occur gradually or rapidly depending on the amount and intensity of exposure. Cherry is strong, moderately hard and has high resistance to shock.

**KNOTTY ALDER:** Western Red Knotty Alder is a smooth, fine-grained hardwood with a straight grain pattern similar to Cherry. The color may vary from pale pinkish-brown to a light tan or honey color. Knotty Alder is chosen for its rugged appearance. *Knots will be random in size and distribution and will range from tight sound knots to very rustic, split and open knots.* Knotty Alder is moderately lightweight with low shock resistance. **Knotty Alder doors are available pre-hung in solid wood Alder jams. If a value priced composite jamb is preferred, Knotty Alder doors can be pre-hung in Birch composite jams. See Jamb Availability Charts.**

**SELECT ALDER:** Select Alder shares the basic characteristics of Knotty Alder; smooth, straight grain pattern similar to Cherry and color that ranges from pale pinkish-brown to light tan or honey color. Select Alder has a less rustic appearance than Knotty Alder, with few, smaller, open knots.

**PAINTABLE MDF:** MDF Core stiles feature hardwood "channel" construction to provide strength and durability for hinge/hardware attachment. Carved MDF panels are not only cost effective but they offer an ideally smooth surface for superb paint adherence. Doors are shipped from the factory with a base primed finish. Please note that additional sanding is required before jobsite finishing.

## FINISH DETAILS

### SPRAY STAIN (no-wipe) FINISH DETAILS

#### SPRAY STAIN FINISH

Doors are carefully sanded to develop an exceptional surface that is ready to finish. A transparent stain is sprayed over the surface of the wood and allowed to penetrate and develop the grain. "Raised" panel door styles specified with Spray Stain are unable to be pre-finished (stained) on the profiles.

A protective, catalytic sealer, chosen for its excellent adhesion, moisture resistance and sealing qualities. The surface is then fine-sanded by hand to develop a satiny-smooth surface for the topcoat.

A tough, catalytic conversion varnish topcoat is applied with airless spray. This catalyzed conversion varnish finish was chosen to provide an exceptionally beautiful luster that is impervious to moisture and virtually all household chemicals. A "Spray" stain finish seals and protects your Interior Doors from scratches, dents and chips and provides a beautiful, smooth and durable finish. See page 21 for Spray Stained Finishes.

### GLAZED FINISH

#### GLAZED SPRAY STAINS

To achieve a "Glazed" Finish, the wood is carefully sanded, stained and sealed as usual. After the sealer is fine-sanded and dust is removed, glaze is hand applied to the profiled areas of the door and then wiped off leaving the characteristic "glaze hang-up" in crevices and corners. The glaze is allowed to cure before it is sealed, fine-sanded and topcoated. *(Due to the artistic nature of a "Glaze" finish, a door cutaway is recommended before ordering.)*

See page 21 for Glazed Spray Stain Finishes.

#### UNFINISHED (Machine-Sanded):

Center panels are individually machine-sanded to smooth the profile. After assembly, the entire door is machine-sanded to flush the joints and create a smooth, uniform surface. Additional *hand-sanding is required at the jobsite* before finishing to remove handling marks, cross-grain machine sanding marks and surface blemishes. *Catalog pricing is for unfinished doors.*

*\*Unfinished doors are warranted for five (5) years. If doors are not sealed and properly protected from humidity, finish problems and warping can occur.*

#### "BASE" PRIMER (Paintable doors only):

Panels are individually hand-sanded before a "Paintable" door is assembled. Once the door is assembled, the entire door is carefully machine-sanded and then hand-sanded. The entire door then receives one coat of catalyzed conversion varnish primer. Stiles and rails are then coat-sanded prior to packaging and delivery.

*Please note that additional sanding is required before jobsite finishing to ensure good adhesion.*

# General Information

As seen in the Spray Stain Collection Color Block Box

## STANDARD SPRAY STAIN FINISH CHART

| FINISH       | RED OAK | POPLAR | CHERRY | MAPLE | BIRCH | SELECT ALDER | KNOTTY ALDER |
|--------------|---------|--------|--------|-------|-------|--------------|--------------|
| Linen        | X       |        |        | X     |       |              |              |
| Natural      | X       |        | X      | X     | X     | ✓            | X            |
| Butternut    | X       |        | X      | X     | X     | ✓            | X            |
| Fawn         |         |        | X      | X     |       |              |              |
| Bisque       |         |        |        | X     |       |              |              |
| Shortbread   | X       |        | X      | X     |       | ✓            | X            |
| Allspice     | X       |        | X      | X     | X     | ✓            | X            |
| Truffle      | X       |        |        | X     | X     | ✓            | X            |
| Pecan        |         | X      | X      |       |       | ✓            | X            |
| Clove        | X       | X      | X      |       | X     | ✓            | X            |
| Ginger       |         | X      | X      |       | X     | ✓            | X            |
| Plumwood     |         | X      | X      |       |       | ✓            | X            |
| Walnut       | X       | X      | X      |       |       | ✓            | X            |
| Alpine White |         |        |        | X     |       |              |              |

SATIN SHEEN TOPCOAT

- ◆ Finish areas in the charts shown designated with an "X" represent wood/finish colors that are available **and** included within a Color Block Box. (For Select Alder, use the Knotty Alder color blocks as referenced.)
- ◆ Finish areas in the charts shown designated with a "✓" represent wood/finish colors that are available but **not** included within a Color Block Box.
- ◆ "Blank" wood/finish areas in the charts shown are available but **not** included within a Color Block Box. These finishes are non-recommended due to variance in color consistency from the reaction to a particular wood density (species). A color sample must be generated for customer approval and returned to Woodharbor before placing your order with these wood/finish combinations.

As seen in the Spray Stain Collection Color Block Box

## GLAZE/SPRAY STAIN FINISH CHART

| GLAZE FINISH                     | RED OAK | CHERRY | MAPLE | SELECT ALDER | KNOTTY ALDER |
|----------------------------------|---------|--------|-------|--------------|--------------|
| Natural <i>Pearle</i> Glaze      |         |        | X     |              |              |
| Butternut <i>Pearle</i> Glaze    |         |        | X     |              |              |
| Natural <i>Chocolate</i> Glaze   |         | X      | X     |              |              |
| Butternut <i>Chocolate</i> Glaze |         |        | X     | ✓            | X            |
| Fawn <i>Chocolate</i> Glaze      |         | X      |       |              |              |
| Allspice <i>Chocolate</i> Glaze  | X       |        |       | ✓            | X            |
| Natural <i>Fudge</i> Glaze       | X       | X      |       | ✓            | X            |
| Butternut <i>Fudge</i> Glaze     | ✓       | X      | X     | ✓            | X            |
| Shortbread <i>Fudge</i> Glaze    | ✓       | X      | X     | ✓            | X            |
| Allspice <i>Fudge</i> Glaze      | ✓       |        | X     | ✓            | X            |
| Clove <i>Black</i> Glaze         |         | X      |       | ✓            | X            |
| Walnut <i>Black</i> Glaze        | X       | X      |       | ✓            | X            |
| Plumwood <i>Black</i> Glaze      |         | X      |       | ✓            | X            |

SATIN SHEEN TOPCOAT

## RICHMOND (R041) PASSAGE DOORS

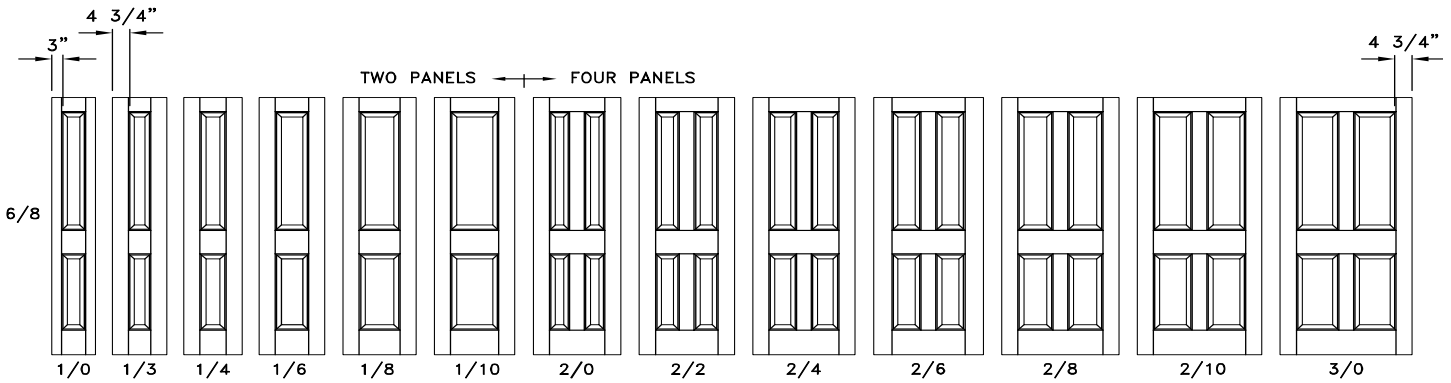

\*Doors less than 2/0 wide receive 2 panels.

## RICHMOND (R041) DOUBLE DOORS

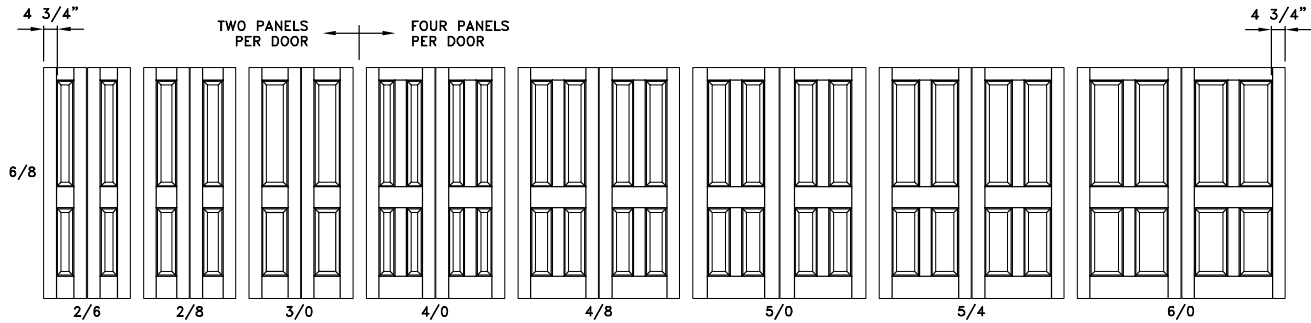

## RICHMOND (R041) BI-FOLD DOORS

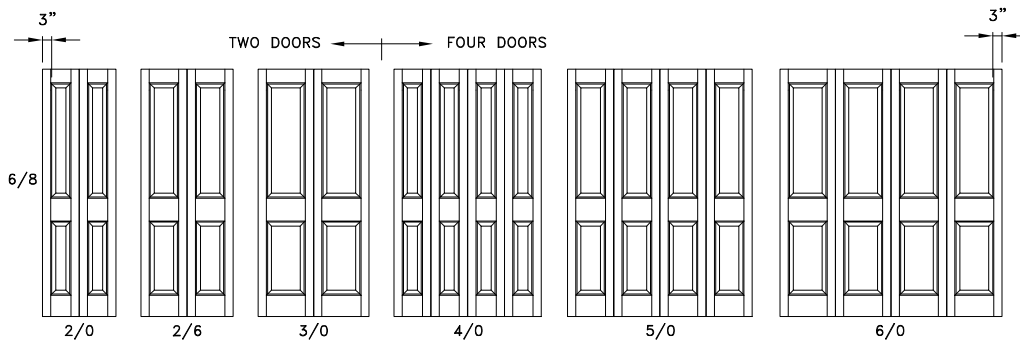

\*Bi-fold doors less than 4/0 wide receive 2 door slabs.

# General Information

## RICHMOND (R041) PASSAGE DOORS - 20 SERIES

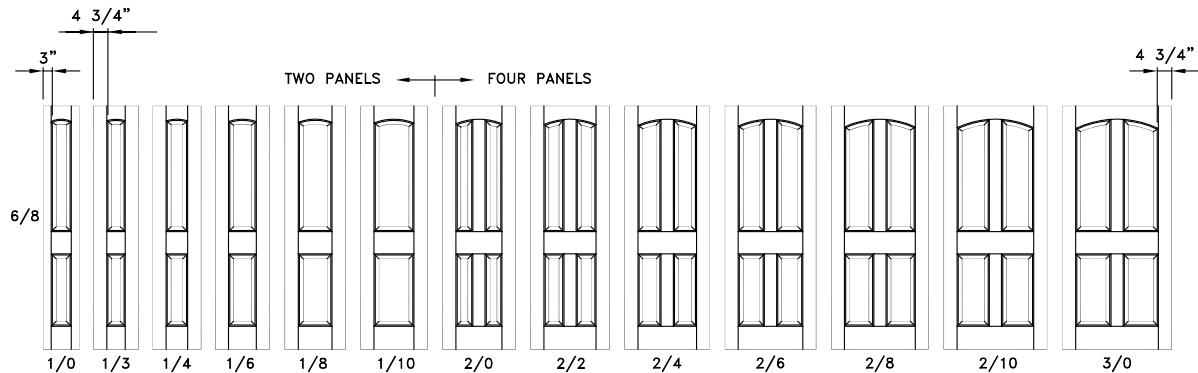

\*Doors less than 2/0 wide receive 2 panels.

## RICHMOND (R041) DOUBLE DOORS (STD. ARCH) - 20 SERIES

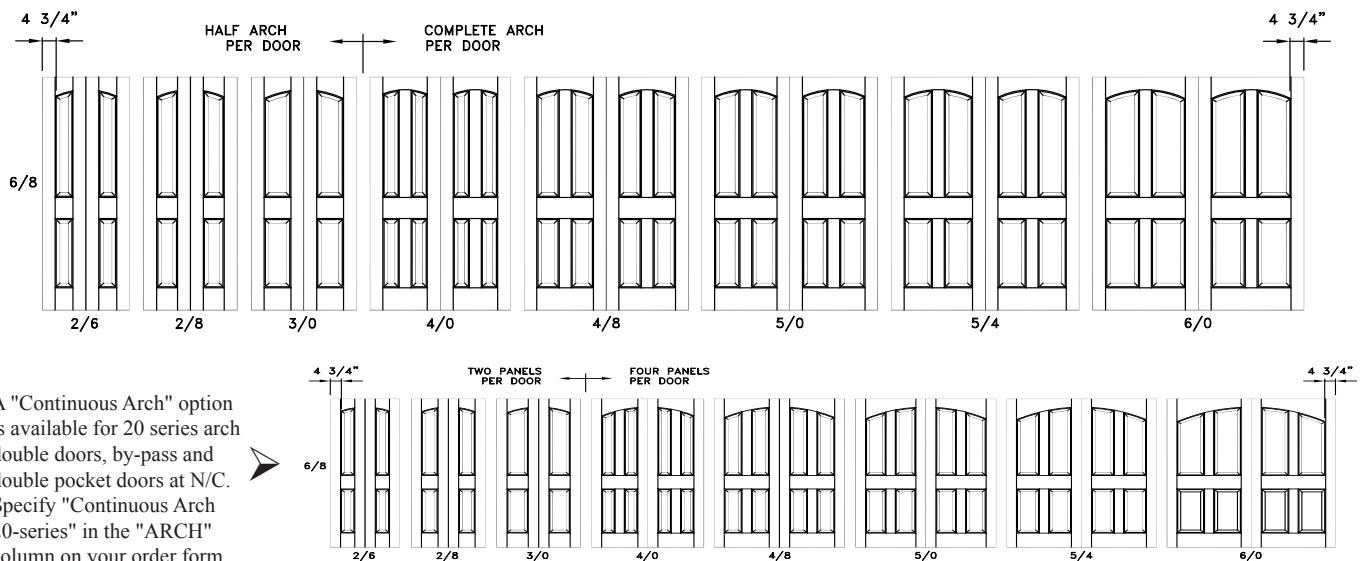

A "Continuous Arch" option is available for 20 series arch double doors, by-pass and double pocket doors at N/C. Specify "Continuous Arch 20-series" in the "ARCH" column on your order form.

## RICHMOND (R041) BI-FOLD DOORS - 20 SERIES

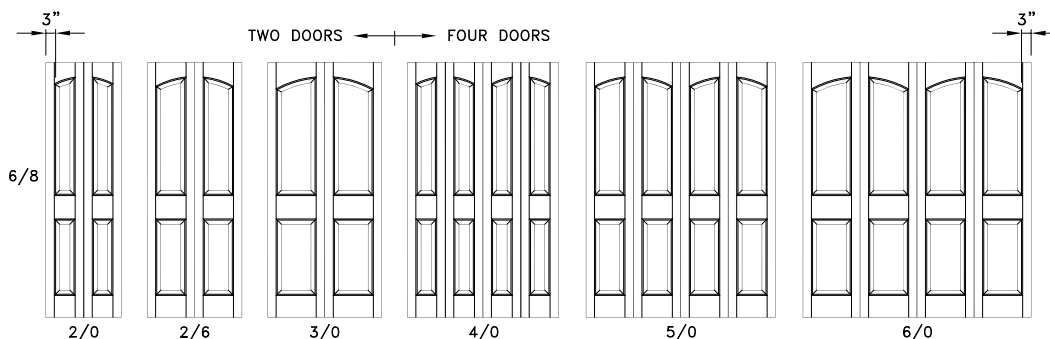

\*Bi-fold doors less than 4/0 wide receive 2 door slabs.

**RICHMOND (R041) PASSAGE DOORS -**

**30 SERIES**

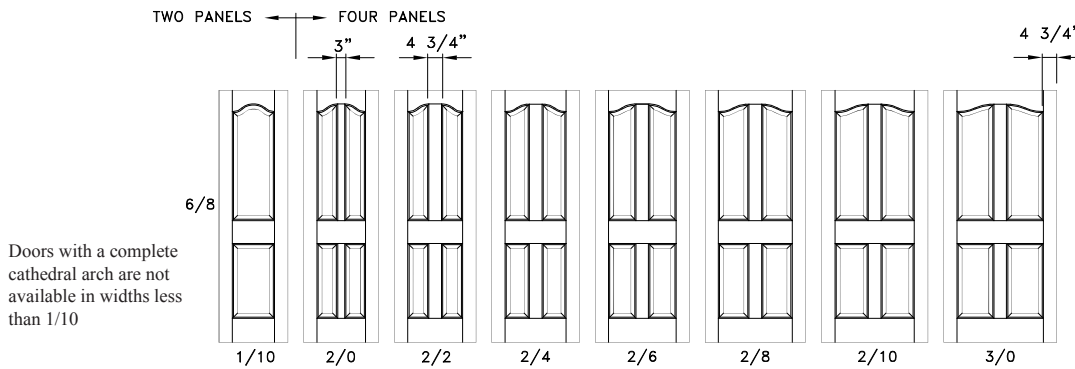

Doors with a complete cathedral arch are not available in widths less than 1/10

\*Doors less than 2/0 wide receive 2 panels.

**RICHMOND (R041) DOUBLE DOORS -**

**30 SERIES**

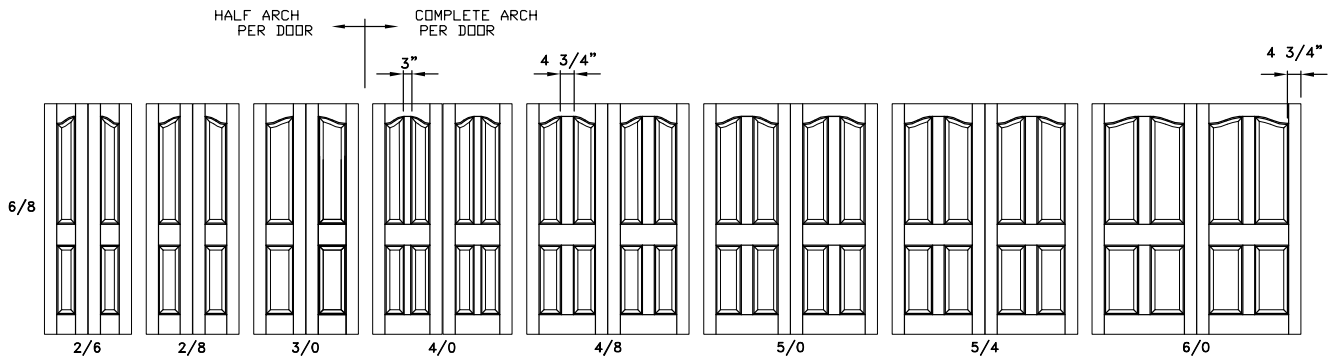

**RICHMOND (R041) BI-FOLD DOORS -**

**30 SERIES**

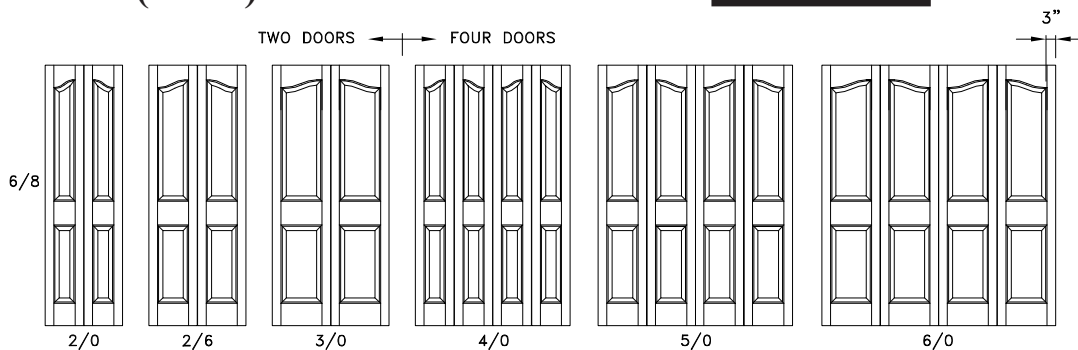

\*Bi-fold doors less than 4/0 wide receive 2 door slabs.

# PRAIRIELAKE

## 100 Year Limited Warranty

All PrairieLake® residential interior doors manufactured by Woodharbor, Inc. (except those doors specifically excluded from the warranty in the provisions below) are warranted only to the original buyer/homeowner of such doors for a period of one-hundred (100) years from the date of shipment from Woodharbor. Woodharbor agrees to provide products of good materials and workmanship at the time of shipment and to be free of defects that would render those doors unserviceable or unfit for their ordinary, recommended use.

If, upon receipt of a shipment, any door is found to have a defect which can be reasonably discovered by inspection of that door, Buyer must, prior to installing, hanging or fitting the door and within thirty (30) days of the received date, send written notice of the discovered defect(s) to Woodharbor, Inc., 3277 9th Street SW, Mason City, Iowa 50401. If a defect is discovered or occurs after a door is installed, written notice of the defect must be sent to Woodharbor within 5 years from the original date of shipment. Buyer shall not return any goods until Woodharbor has been provided a reasonable opportunity to inspect the goods at Buyer's premises to determine whether a defect exists. Woodharbor shall not be responsible for any goods repaired, returned or replaced without prior, written consent.

Action on any claim for warp or telegraphing defects may be deferred, at the option of Woodharbor, for a period not to exceed twelve (12) months from the date of the claim. If a door has been installed prior to such claim being made, the door must remain hung in the original installation during the period of deferral to permit doors to acclimate to temperature and humidity conditions.

If warranted doors are found to contain defects covered under this limited warranty, Woodharbor may, at its option, either; (1) repair the door(s) without charge; (2) replace the door(s) without charge; or (3) refund the purchase price of the door(s) to Buyer. IN NO EVENT SHALL WOODHARBOR PAY FOR THE COST OF LABOR, INSTALLATION OR FINISHING OF THE REPLACEMENT DOOR(S) OR ORIGINAL DOOR(S) OR FOR ANY OTHER COST RELATING TO THE REPLACEMENT OF THE DOOR(S), ALL OF WHICH SHALL BE THE SOLE RESPONSIBILITY OF THE PERSON MAKING THE WARRANTY CLAIM.

The following are not to be considered defects in material or workmanship and are not covered by this limited warranty:

- A. Any condition or appearance caused by failure to follow PrairieLake's "Handling, Installation & Finishing Instructions".
- B. Natural variations in the color, grain and texture of wood or the appearance of any field-finished doors.
- C. Warp which does not exceed 1/4" in the plane of a 7/0 door or within a 3/0 x 7/0 section of an 8/0 door. Warp is any distortion in the door itself and does not refer to the door in relation to the frame or jamb in which it is hung. The term "warp" shall include bow, cup and twist. Warp is measured by placing a straight edge on the suspected concave surface of the door at any angle (horizontally, vertically, diagonally) with the door in its installed position. The measurement of warp shall be made at the point of maximum distance between the straight edge and the face of the door.

- D. Splitting of panels which does not allow light to show through. Checks and small splits generally occur in hardwoods as a natural characteristic and are not considered defects unless the split allows light to show through.
- E. Unfinished doors are warranted for five (5) years. This warranty does not cover the appearance or application of field-applied finishes. "Unfinished" doors must be thoroughly sealed and finished according to PrairieLake's written "Handling, Installation & Finishing" instructions to qualify for any warranty claims.
- F. Doors that are improperly installed or do not swing freely.
- G. Any moisture/humidity related concerns. Any condition arising from the Buyer's neglect or failure to properly maintain the door(s).
- H. Any damage caused by others or by any cause beyond the control of Woodharbor including, but not limited to, damages caused by misuse, abuse, accident or mishandling or by fire, flood, earthquake, storm, tornado or other acts of nature.
- I. Any doors used for commercial installations. Commercial doors are warranted for 5 years if they are finished by Woodharbor. Unfinished doors are warranted for 1 year.
- J. Any doors used for exterior purposes.
- K. Doors shipped outside the continental United States are warranted for 5 years if ordered with a factory finish, or for 1 year if ordered Unfinished. For any warranty claims, Woodharbor must be provided opportunity, upon request, to view doors at Buyer's premises

NOTWITHSTANDING ANY OTHER PROVISIONS IN THIS LIMITED WARRANTY, WOODHARBOR EXPRESSLY DISCLAIMS AND EXCLUDES ALL OTHER WARRANTIES, EXPRESSED OR IMPLIED, INCLUDING THE WARRANTIES OF MERCHANTABILITY AND FITNESS FOR A PARTICULAR PURPOSE, AND ALSO DISCLAIMS AND EXCLUDES ALL LIABILITY FOR INCIDENTAL, CONSEQUENTIAL, INDIRECT OR ANY OTHER SPECIAL DAMAGES OF BUYER, INCLUDING LOST PROFITS, FOR BREACH OF WARRANTY, OR OF CONTRACT OR OTHERWISE. THIS WARRANTY IS THE SOLE AND EXCLUSIVE REMEDY OF BUYER AGAINST WOODHARBOR.

This warranty gives you specific legal rights, and you may also have other rights which vary from state to state. Some states do not allow the exclusion or limitation of implied warranties or of incidental and consequential damages, so this limitation or exclusion may not apply to you. IN SUCH CASE, THE DURATION OF ANY IMPLIED WARRANTY SHALL BE THE SAME AS THAT OF THE EXPRESSED WARRANTY AS STATED HEREIN.

**PRAIRIELAKE**®  
*Interior Doors by* WOODHARBOR

WOODHARBOR DOORS & CABINETRY, INC.  
100 ENTERPRISE DRIVE ■ NORTHWOOD, IA 50459

# PRAIRIELAKE®

## *Handling, Installation & Finishing Instructions*

### STORAGE/HANDLING

Handle doors carefully with clean gloves and clean equipment. Do not drag the doors across one another.

Store doors above grade, lying flat on a level surface, in a dry, well-ventilated building with an operational HVAC system. Do not expose doors to excessive humidity, moisture, heat, dryness or direct sunlight. Keep the doors covered but allow air circulation. Do not stack doors on end or prop at an angle.

Doors should not be subjected to abnormal or extreme changes in temperature or humidity. **Doors must be allowed time to acclimate to the average humidity conditions of the jobsite before hanging.** Average humidity conditions of the jobsite or storage facility must be monitored and maintained at 40%-50% during storage, installation and occupancy. Extreme humidity levels are likely to cause problems.

If unfinished doors are to be stored for more than 5 days, the entire door, including all edges and bored holes, should be thoroughly sealed to prevent moisture absorption. (See Finishing Instructions.)

### INSTALLATION

Do not deliver/install doors until concrete floors, foundations and plaster/dry wall are completely dry and HVAC system is operational.

Prior to installation, doors must be acclimated to the average humidity conditions of the jobsite for at least 72 hours.

When hanging the doors, be sure to allow adequate clearance for swelling of door or jamb in extreme damp conditions.

We do not recommend trimming the doors in width. If width trim is necessary, do not trim more than 1/8" off each side. Top and bottom edges can be trimmed a maximum of 1" each. (If trimming is necessary, all trimmed edges must be thoroughly sealed with a protective finish to prevent moisture absorption.) **The structural integrity of the door cannot be impaired in the fitting of the door or application of hardware or special details.**

Use three hinges on 7/0 or 6/8 high doors, and use four hinges for 8/0 doors. Hinges must be set in a straight line, flush with the face of the door and frame to prevent distortion and binding. Be sure that jambs and stops are set perfectly square and plumb.

**PRAIRIELAKE®**  
*Interior Doors by* WOODHARBOR

WOODHARBOR DOORS & CABINETRY, INC.  
100 ENTERPRISE DRIVE, NORTHWOOD, IA 50459

### FINISHING

Factory finished doors do not require additional finishing. However, if doors are trimmed or require additional jobsite machining for hinges, latchsets or other hardware, all trimmed edges and machined areas must be thoroughly sealed before installation.

If doors are to be stored more than 5 days, make sure entire door, including top and bottom edges and bored holes, is thoroughly sealed and/or finished.

Doors must be finished immediately after fitting or hanging and before hardware is installed. All trimmed edges and machined areas must be thoroughly sealed. Avoid finishing doors during periods of higher than average humidity. Doors should be finished in a horizontal position if possible.

Sand entire door thoroughly with a fine grit sandpaper (150 or 180). A thorough hand-sanding is important to remove surface blemishes, handling marks, cross-grain scratches, etc. to achieve a consistent finish. Sand with the direction of the grain only. Remove dust with a tack cloth before finishing.

Always use high quality stains, paints or primer and follow manufacturers instructions carefully. **All surfaces, edges and machined areas of the door must be finished and/or sealed.**

Apply 2-3 coats of topcoat (i.e. varnish, polyurethane, lacquer, etc.) and sand lightly between each coat. Remove dust with a tack cloth before applying next coat.

After the door is finished, the "floating panels" may move or "breathe" slightly revealing an unfinished edge. Minor touch-up with stain/sealer or paint will finish the exposed edge.

Some species of wood, Red Oak particularly, can contain chemicals which react unfavorably with certain finishes. Where possible, the surface should be tested for unfavorable reactions. Application of a sealer before finishing can sometimes prevent this difficulty.

The PRAIRIELAKE warranty does not cover the appearance or application of field-applied finishes. The above finishing instructions are meant as general guidelines only. Always use high-grade finish products and follow manufacturer instructions carefully.

NOTE: Failure to comply with these written guidelines for handling, installing and finishing PRAIRIELAKE doors will negate any warranty claims.