

# CastPointe<sup>®</sup>

*Cabinetry by* WOODHARBOR

*Bring your home  
to life.*

# CastPointe Frameless Construction Details

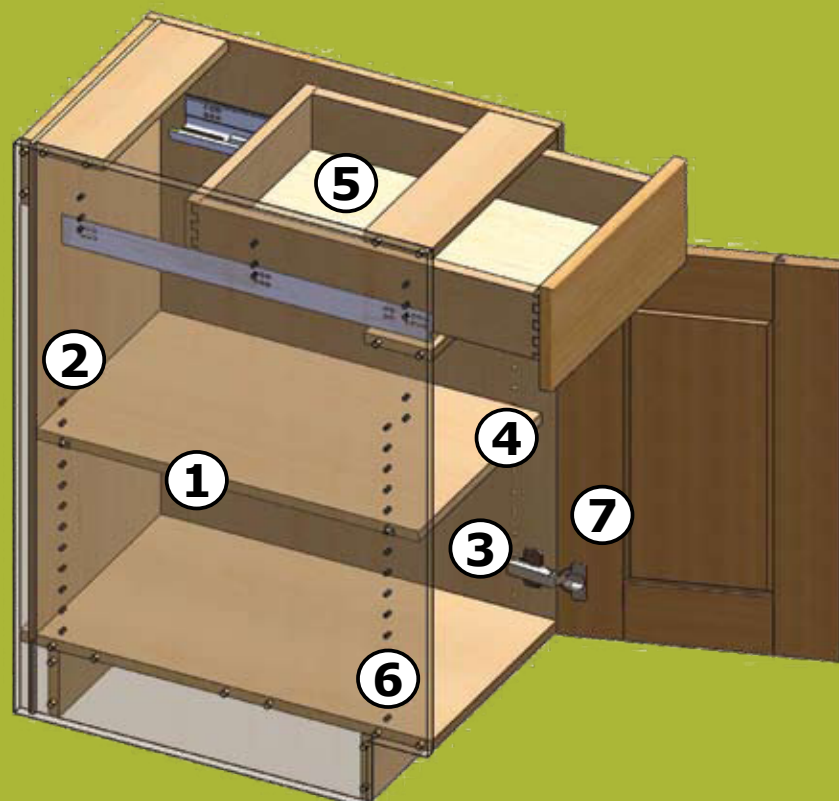
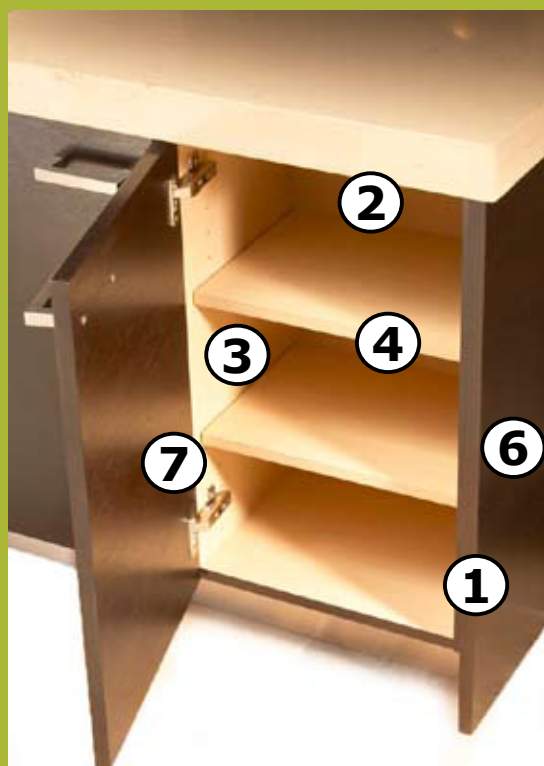

## 1. **Cabinet Sides, Floor, and Ceiling**

$\frac{5}{8}$ " composite board with durable, natural wood grain or coordinating white melamine with dowel and glue joinery.

*All composite board is EPP 100% recyclable product.*

## 2. **Cabinet Back**

$\frac{1}{4}$ " thick composite board with natural wood grain or coordinating white melamine.

## 3. **Cabinet Interior**

Durable melamine with natural wood grain or coordinating white melamine. *A matching Finished Interior (FI) is available as an upgrade.*

## 4. **Cabinet Shelves**

$\frac{5}{8}$ " thick composite board with natural wood grain or coordinating white melamine.

## 5. **Drawer Box Construction**

$\frac{3}{4}$ " solid Aspen dovetailed sides with a  $\frac{1}{4}$ " thick captive bottom with Blum® full extension undermount slides.

*(Blumotion 'soft-close' slides are available as an upgrade)*

## 6. **Cabinet Exterior Ends**

All exposed ends are natural wood grain or coordinating white melamine. *(Finished ends are available in a matching wood veneer as an upgrade)*

## 7. **Hinge Options**

107° clip hinge with a lifetime guarantee. *(Blumotion 'soft-close' hinges are available as an upgrade)*

**CastPointe**<sup>®</sup>  
*Cabinetry by* WOODHARBOR

# Door STYLES

CASTPOINTE FRAMELESS CABINETRY styles and finish options stand on their own beautiful merits. And they also complement or match all of Woodharbor's other lines of Cabinetry & Doors.



**WAKEFIELD**  
Coastal White Enamel



**PORTLAND**  
Maple, Allspice



**WATERBURY**  
Cherry, Walnut



**MADISON**  
Cherry, Pecan



**SEABROOK**  
Maple, Butternut



**CHELSEA**  
Cherry, Espresso



**PENNINGTON**  
Maple, Butternut/Chocolate Glaze



**FRESNO**  
Quarter Sawn White Oak, Clove



**BARSTOW**  
Maple, Natural



**PACIFICA**  
Quarter Sawn White Oak, Espresso



**GEORGETOWN**  
Cherry, Clove/Black Glaze



**SAVANNAH**  
Cherry, Ginger



**ASHLAND**  
Cherry, Clove



**PROVENCE**  
Cherry, Ginger



**WORTHINGTON**  
Cherry, Walnut/Black Glaze



**SOMERLAKE**  
Designer White Enamel



**BRITTANY**  
Coastal White Enamel/Sable Glaze



**MALIBU**  
Maple, Butternut



**RIVERSIDE**  
Quarter Sawn White Oak, Clove



**MONTEREY**  
Quarter Sawn White Oak, Espresso



**BAYSIDE**  
Coastal White Melamine

# Finish OPTIONS

MAPLE		CHERRY/CHARACTER CHERRY		QUARTER SAWN WHITE OAK	PAINTABLE	
STD SPRAY FINISH	GLAZE/SPRAY FINISH	STD SPRAY FINISH	GLAZE/SPRAY FINISH	STD SPRAY FINISH	ENAMEL FINISH	
Natural	Butternut/Chocolate	Pecan	Clove/Black	Clove	Designer White	
Butternut	Allspice/Fudge	Clove	Walnut/Black	Espresso	Coastal White	
Allspice		Ginger	Espresso		Coastal White/Sable	
		Walnut				

*Espresso Classic Finish is offered in Clear Cherry only, not Character Cherry*

*Accuracy of reproduced color is subject to printing limitations. Please review actual color samples and displays before selecting a finish.*



Easy-opening up and over lift system will ensure easy access to cabinet interior. Door remains open in any desired position.



Easy-opening bi-fold door lift system features effortless door closure system. Doors remain in position.

Cabinets include adjustable sliding baskets of heavy gauge chrome-wire for optimum corner storage.



Tandem undermount full-extension drawer slides with optional soft-close are affordable options, as are soft-close door hinges.

# Wood OPTIONS



MAPLE



CHERRY



CHARACTER CHERRY



QUARTER SAWN WHITE OAK

*For you to fully appreciate the natural characteristics of our wood species, these samples are shown with a natural finish.*

### MATCHING DOORS & CABINETS

For the highest level of interior design and consistency, Woodharbor offers you beautifully crafted Cabinetry & Doors in matching or complementary styles, woods & finishes. All our product lines are created to fit with one another perfectly in countless ways.



### QUALITY PRODUCTS, HEALTHY ENVIRONMENT

The manufacturing of all Woodharbor products is certified by the Kitchen Cabinet Manufacturers Association for promoting green principles and renewal of natural resources. We at Woodharbor care deeply about our customers, our products, our employees and the world we all share.



*Bring your home  
to life.*

FOR MORE INFORMATION, CONTACT YOUR AUTHORIZED CASTPOINTE FRAMELESS CABINETS DEALER.

**CastPointe**  
*Cabinets by* WOODHARBOR

Woodharbor Doors & Cabinetry, Inc.  
3277 Ninth Street SW, Mason City, Iowa 50401

Visit us on the web at [www.woodharbor.com](http://www.woodharbor.com)



**CastPointe**  
*Cabinets by* WOODHARBOR

*Bring your home  
to life.*